

UNIVERSAL ATOMIC DIESEL

MODEL 40

5432 (32H.P.)

PARTS MANUAL

medalist 

Universal Motors

PRIOR TO SERIAL NO. 315023

	<u>PAGE NO.</u>
CRANKCASE GROUP	1 - 2 - 2A - 3 - 3A
CYLINDER HEAD GROUP	4
GEAR CASE GROUP	5 - 6
BEARING CASE GROUP	7 - 7A - 8 - 8A
HEAD COVER GROUP	9 - 9A
BREATHER GROUP	10
FUEL PUMP	10
CAMSHAFT GROUP	11 -11A
VALVE, ROCKER ARM GROUP	12
PISTON, CRANKSHAFT GROUP	13
FLYWHEEL GROUP	14 -15
NOZZLE HOLDER GROUP	16 -16A-17
FUEL CAMSHAFT GROUP	18 - 18A-19 -19A
SPEED CONTROL PLATE GROUP	20
NOZZLE GROUP	21
GOVERNOR GROUP	22
INJECTION PUMP GROUP	23
STARTER GROUP	24
OIL FILTER GROUP	25
WATER PUMP GROUP - CIRCULATING	26 -26A
FUEL FILTER GROUP	27 -27A
AIR CLEANER GROUP	28 -28A
ENGINE MOUNT GROUP	29
TRANSMISSION GROUP	30
THROTTLE LINKAGE CONTROL GROUP	31
ALTERNATOR GROUP	32
COOLING SYSTEM GROUP	33 -34
RAW WATER PUMP	34A
EXHAUST MANIFOLD GROUP	35 -35A

Page 2
(Index Cont'd)

COUPLING	36
INSTRUMENT PANEL	37
WIRING DIAGRAM	38

WHEN ORDERING PARTS, SPECIFY MODEL AND SERIAL NUMBER OF ENGINE.

This information is absolutely essential for the correct execution of your order. We do not hold ourselves responsible for errors or delays where this is lacking.

SERIAL NUMBER LOCATIONS

Stamped on upper left hand corner of block - ignition side - facing flywheel end (front of engine).

Stamped in block directly above flywheel housing, under front oil filler.

On engine nameplate located on reverse gear housing cover.

On engine nameplate located on engine manifold.

RETURNED PARTS

Parts may be returned for credit subject to authorization by the factory, factory inspection and acceptance upon receipt, and a 15% Re-Stocking charge.

A return goods authorization number must be requested from the factory prior to returning the parts.

All return shipments must be fully PREPAID and clearly marked with shipper's name and address.

LOSS OR DAMAGE IN TRANSIT

Our responsibility ceases upon delivery of shipments to the common carrier. Any claims for loss or damage in transit must be filed with the transportation company.

SHORTAGE CLAIMS

All claims for shortage must be filed within ten (10) days after receipt of shipment and must be accompanied by packing list.

ALL ORDERS FOR REPAIR PARTS MUST BE PLACED THROUGH OUR DISTRIBUTOR/DEALER IN YOUR AREA.

MEDALIST - UNIVERSAL MOTORS
P.O. BOX 2508
OSHKOSH, WI 54903

(414)231-4100 Cable UNIMOT

ATTENTION - SERVICE DEPT.

CRANKCASE GROUP

#1

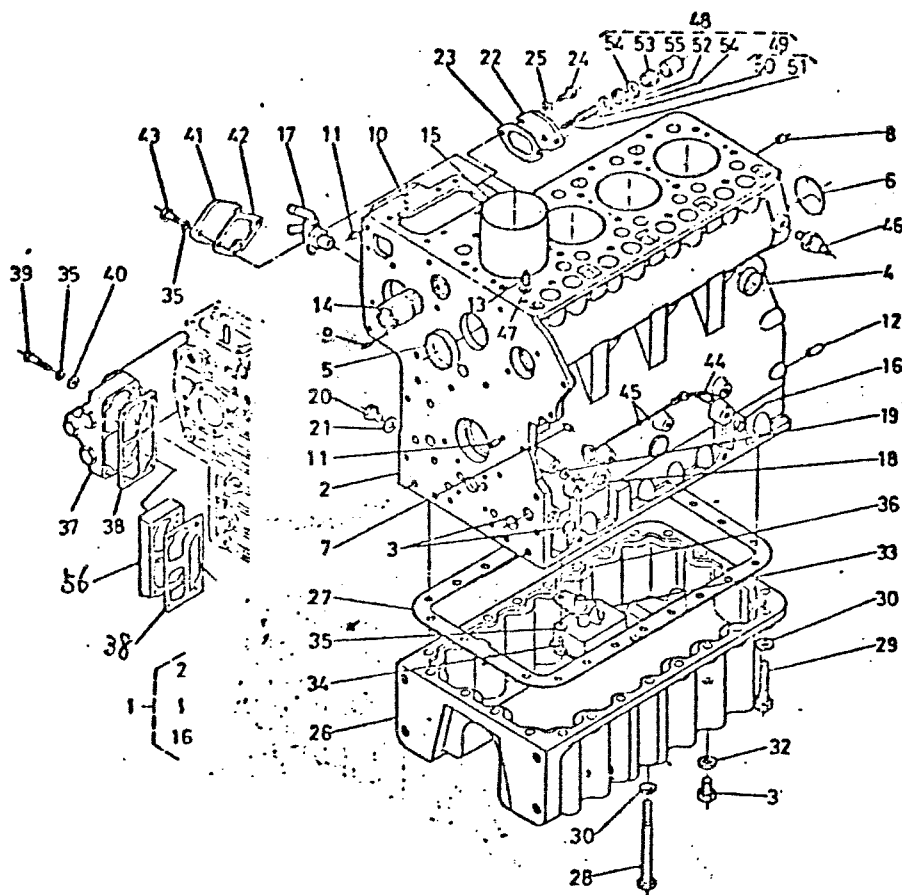

FROM SERIAL NO. 230101 TO 230125
315000 315022

ITEM	PART NO.	DESCRIPTION	UNIT
1	299552	Crankcase Assembly	1
2	N/A	Crankcase	1
3	N/A	Plug, Expansion <i>299352</i>	3
4	N/A	Cap, Sealing	6
5	N/A	Cap, Sealing	2
6	N/A	Plug, Expansion	1
7	N/A	Plug, Pin	2
8	N/A	Plug, Pin	1
9	N/A	Pin, Straight	2
10	N/A	Pin, Straight	2
11	N/A	Pin, Straight	2
12	N/A	Pin, Straight	1
13	N/A	Pin, Pipe	1
14	N/A	Pipe, Water	1
15	298856	Liner, Cylinder	4
16	N/A	Plug	2
17	298664	Cock, Drain	1
18	298658	Plug	5
19	298659	Gasket	5
20	298653	Plug	1
21	N/A	Gasket	1
22	N/A	Cover	1
23	N/A	Gasket	1
24	N/A	Bolt	2

CRANKCASE GROUP

Prior to Serial No. 315023

1

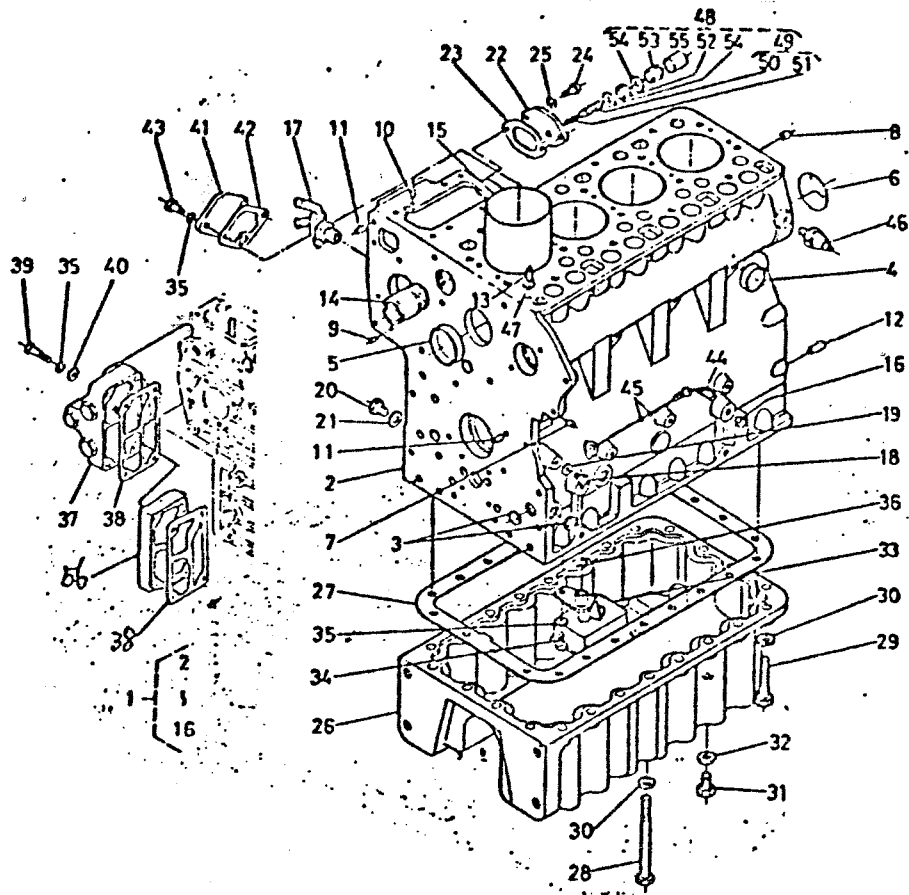

FROM SERIAL NO. 230101 TO 230125
315000 TO 315022

ITEM	PART NO.	DESCRIPTION	UNIT
25	N/A	Washer, Spring	2
26	299565	Oil Pan	1
27	299553	Gasket, Oil Pan	1
28	N/A	Bolt	4
29	N/A	Bolt	20
30	N/A	Washer, Spring	24
31	298660	Plug	2
32	298654	Gasket	2
33	N/A	Filter, Oil	1
34	N/A	Bolt	1
35	N/A	Washer, Spring	7
36	N/A	O Ring	1
37	298860	Assy. Filter, Oil	1
38	298655	Packing	2
39	N/A	Bolt	4
40	N/A	Washer, Plain	4
41	N/A	Cover	1
42	N/A	Gasket	1
43	N/A	Bolt	2
44	298661	Gauge, Oil (dipstick)	1
45	298662	O Ring	2
46	298663	Switch, Oil	1
47	298665	O Ring	1
48	N/A	Assy. Apparatus Idle	1

CRANKCASE GROUP

FROM SERIAL NO. 315023 TO

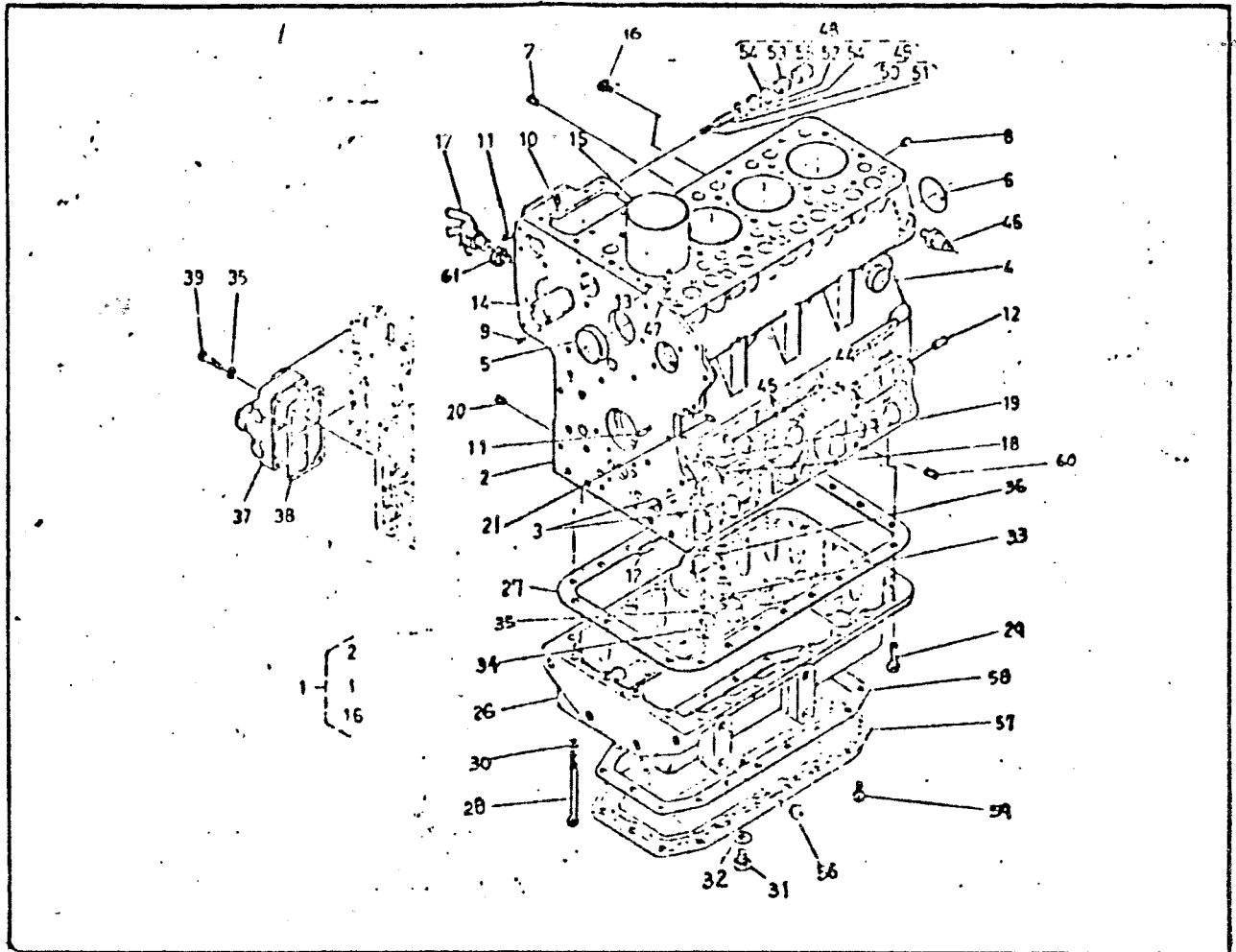

ITEM	PART NO.	DESCRIPTION	UNIT
24			
25			
26	299565	Oil Pan	1
27	299553	Gasket, Oil Pan	1
28	N/A	Bolt	12
29	N/A	Bolt	12
30	N/A	Washer, Spring	12
31	299370	Plug, Oil Pan	1
32	299371	Gasket	1
33	N/A	Oil, Filter Pump	1
34	N/A	Bolt	1
35	N/A	Washer, Spring	5
36	N/A	O Ring	1
37	298860	Mount Housing Assy - Oil Filter	1
38	298655	Gasket, Oil Filter Cover Assembly	1
39	N/A	Bolt	4
40			
41			
42			
43			
44	298661	Dipstick	1
45	298662	O Ring	2
46	298663	Oil (sender)	1

CRANKCASE GROUP

FROM SERIAL NO. 315023 TO

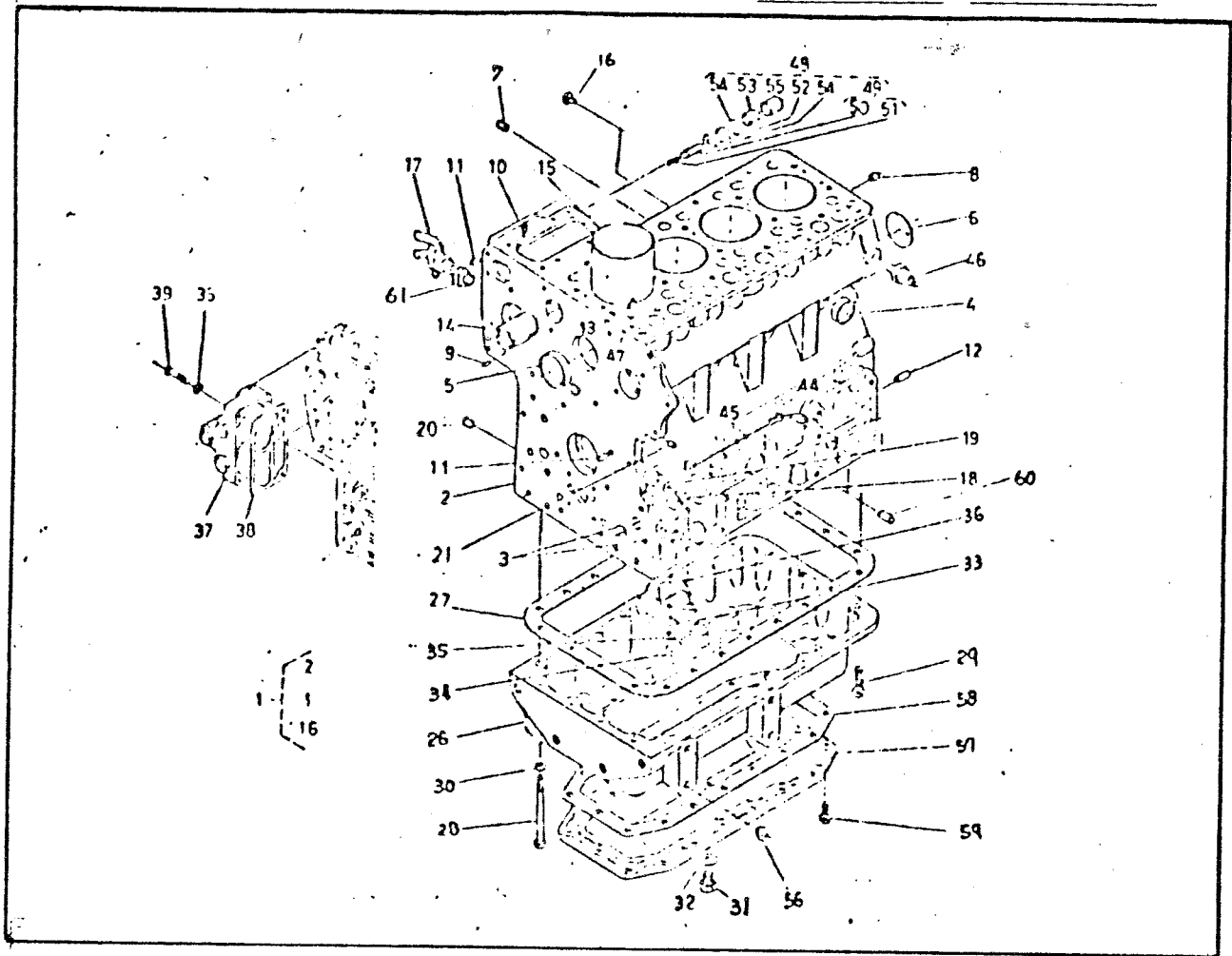

ITEM	PART NO.	DESCRIPTION	UNIT
47	299362	O Ring	1
48	N/A	Assembly Apparatus, Idle	1
49	N/A	Assembly Bolt, Adjusting	1
50	N/A	Bolt, Adjusting	1
51	N/A	Spring	1
52	N/A	Nut	1
53	N/A	Nut, Cap	1
54	N/A	Gasket	2
55	N/A	Cap	1
56	N/A	Plug	8
57	299564	Cover, Oil Pan	1
58	299560	Packing	1
59	N/A	Bolt	18
60	N/A	Plug, Blind	13
61	N/A	Joint, Draincock	1

CYLINDER HEAD GROUP

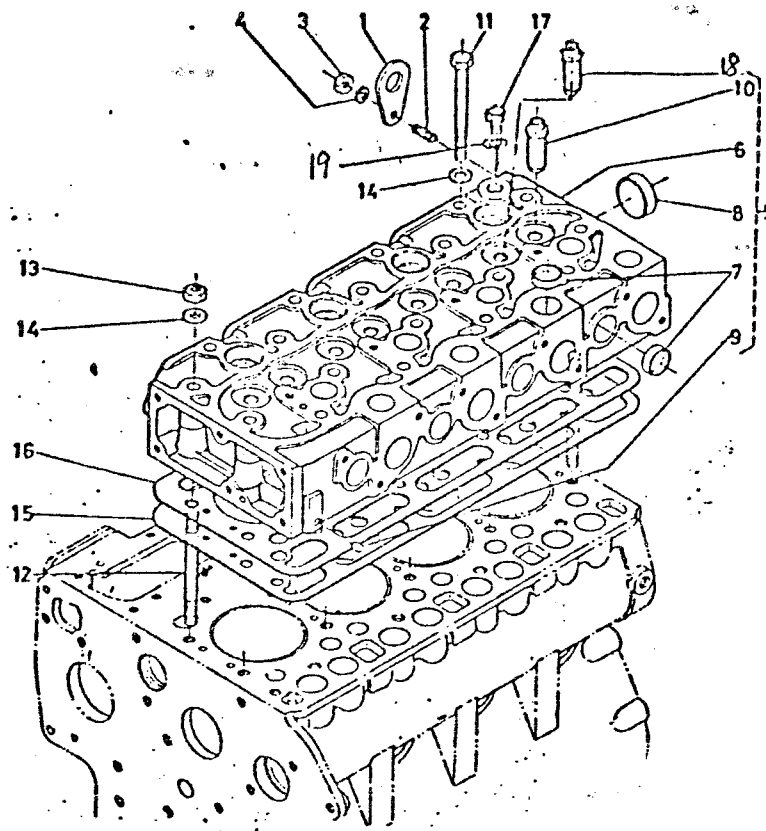

FROM SERIAL NO. 230101 TO 230123
315000 315022

ITEM	PART NO.	DESCRIPTION	UNIT
1	298666	Hook Engine	2
2	N/A	Stud	2
3	N/A	Nut	2
4	N/A	Washer, Spring	2
5	299554	Assy. Cylinder Head	1
6	N/A	Cylinder Head	1
7	N/A	Cap Sealing	12
8	N/A	Cap Sealing	1
9	N/A	Plug, Pin	2
10	299555	Guide, Valve	8
11	298668	Bolt, Cylinder Head	16
12	298669	Stud, Cylinder Head	2
13	298670	Nut, Cylinder Head	2
14	298671	Washer, Plain	18
15	299556	Gasket, Cylinder Head	1
16	299557	Shim, Cyl. Head Gasket	1
17	N/A	Plug	1
18	299558	Guide, Exhaust Valve	4
19	N/A	Packing	1
20			
21			
22			
23			
24			

GEAR CASE GROUP

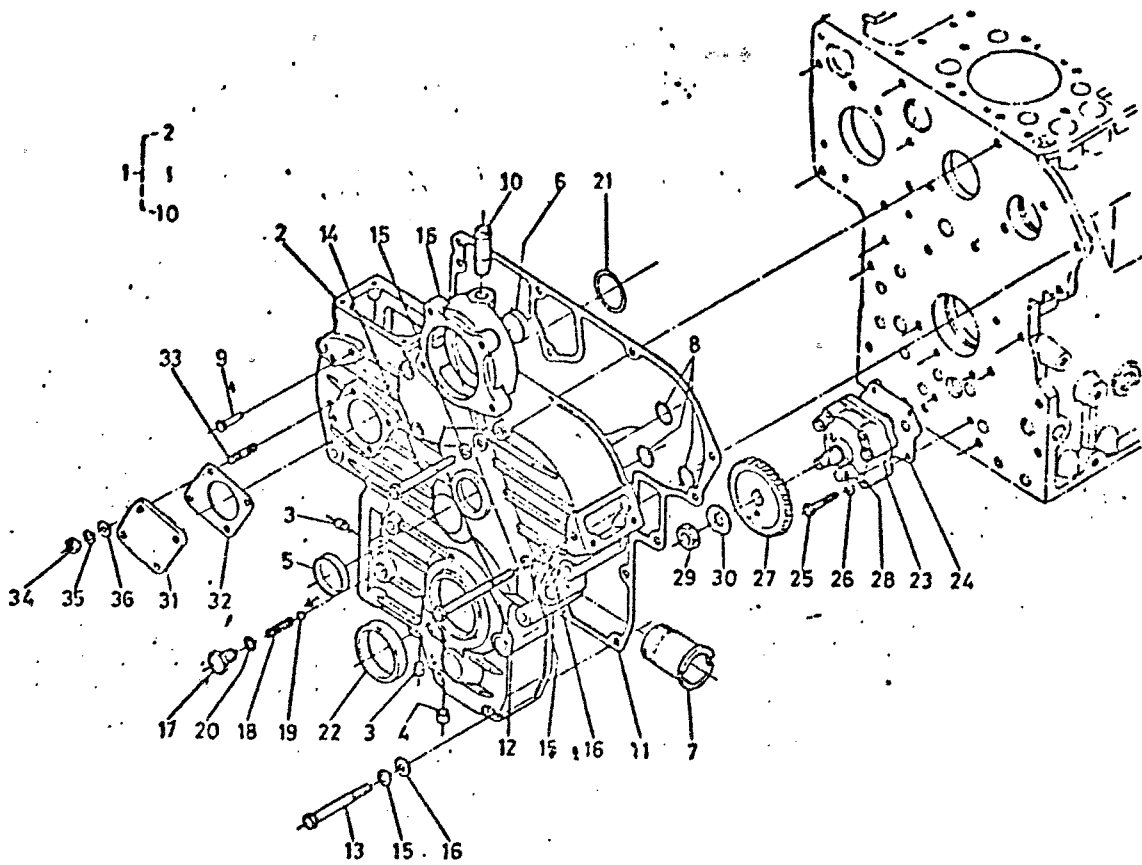

FROM SERIAL NO. 230101 TO 230125
315000 315022

ITEM	PART NO.	DESCRIPTION	UNIT
1	N/A	Assy. Case, Gear	1
2	N/A	Case, Gear	1
3	N/A	Plug, Pin	2
4	N/A	Plug, Pin	1
5	N/A	Cap, Sealing	1
6	N/A	Cap, Sealing	1
7	N/A	Pipe, Water	1
8	299559	O Ring	3
9	N/A	Pin, Start Spring	1
10	N/A	Pipe, Water Return	1
11	298675	Gasket, Gear Case	1
12	N/A	Bolt	1
13	298676	Bolt	10
14	N/A	Bolt	3
15	N/A	Washer, Spring	14
16	N/A	Washer, Plain	14
17	298679	Cap	1
18	298678	Spring	1
19	298677	Ball	1
20	298680	O Ring	1
21	298681	O Ring	1
22	N/A	Seal, Oil	1
23	299561	Assy. Pump, Oil	1
24	N/A	Gasket, Oil Pump	1

GEAR CASE GROUP

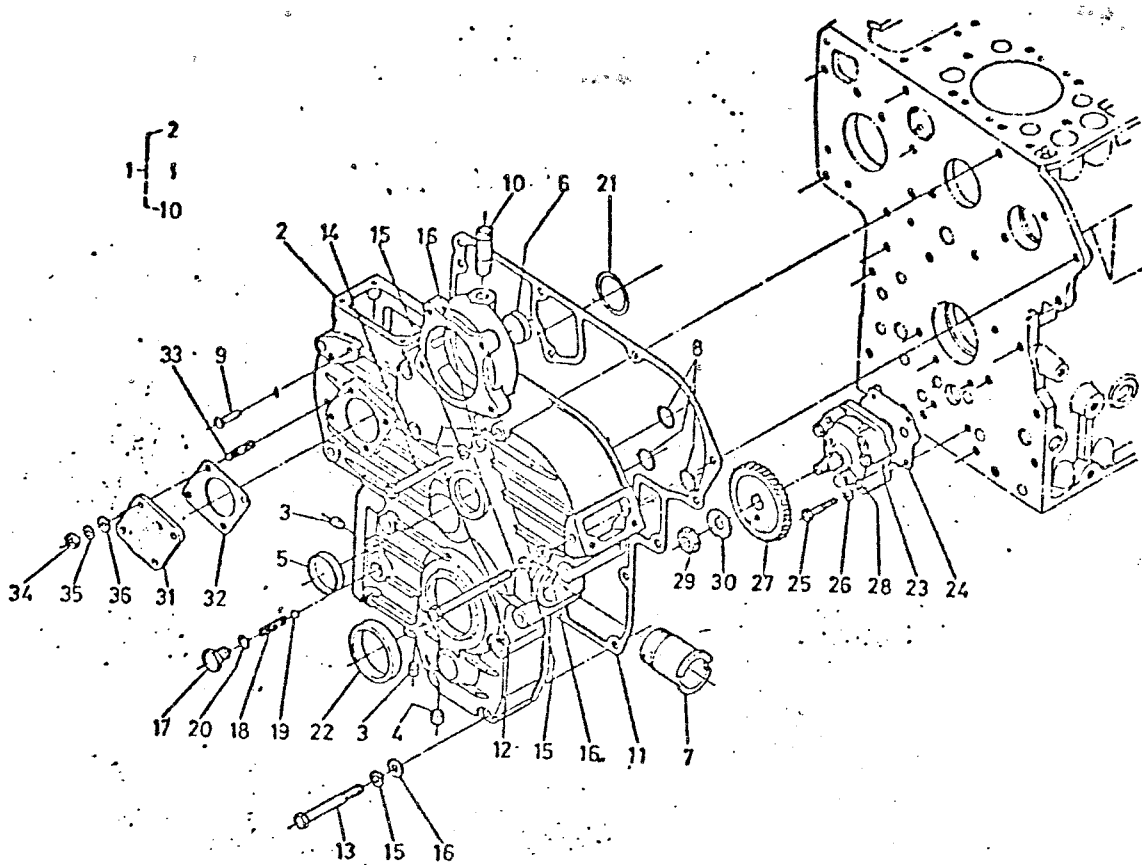

ITEM	PART NO.	DESCRIPTION	UNIT
25	N/A	Bolt	4
26	N/A	Washer, Spring	4
27	299562	Gear, Oil Pump Drive	1
28	N/A	Key, Feather	1
29	N/A	Nut	1
30	N/A	Washer, Claw	1
31	N/A	Cover	1
32	298485	Gasket	1
33	298683	Stud	4
34	298684	Nut	4
35	N/A	Washer, Spring	4
36	N/A	Washer, Plain	4
37	298477	Adaptor Plate, Raw Water Pump Mt'g.	1
38			
39			
40			
41			
42			
43			
44			
45			
46			
47			
48			

BEARING CASE GROUP

Prior to Serial No. 315023

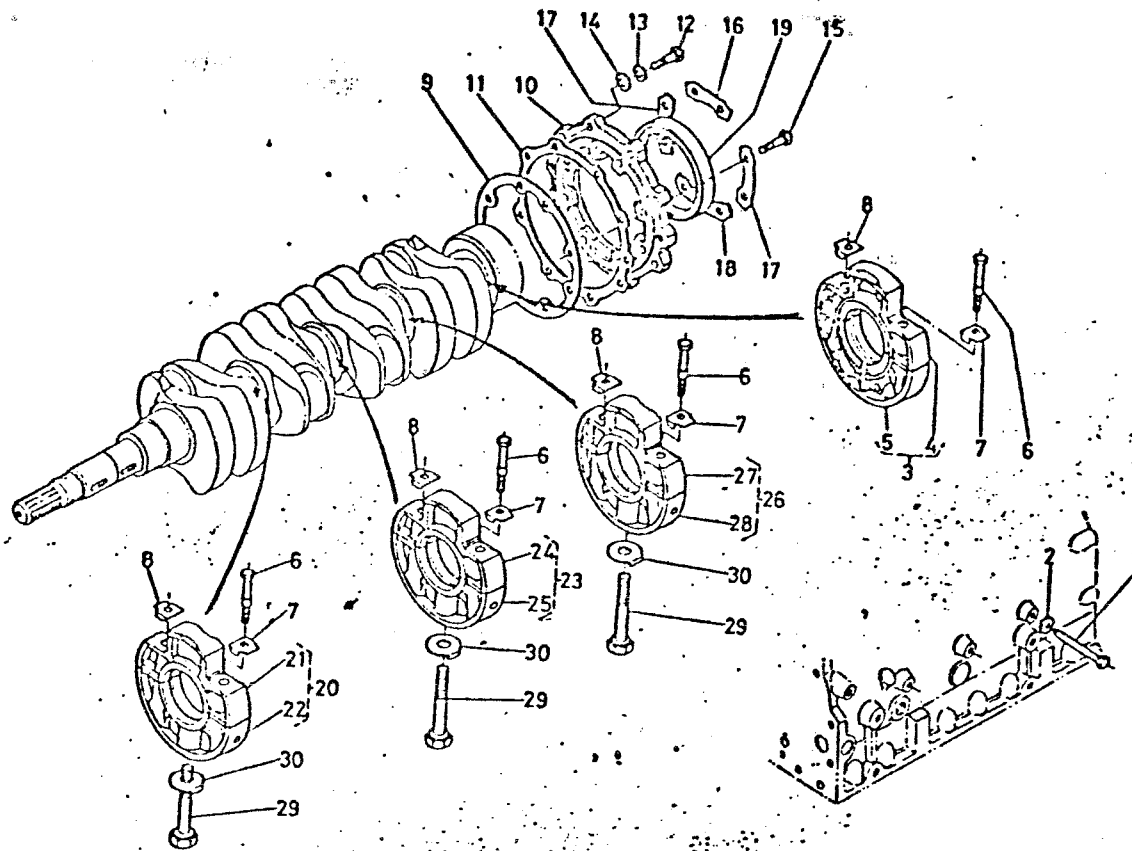

FROM SERIAL NO. 230101 315000 TO 230125 315022

ITEM	PART NO.	DESCRIPTION	UNIT
1	N/A	Bolt, Knock	3
2	N/A	Gasket	3
3	298685	Assy. Case, Bearing	1
4	N/A	Case, Main Bearing 1	1
5	N/A	Case, Main Bearing 2	1
6	298686	Bolt 1	8
7	298687	Washer 1	4
8	298688	Washer 2	4
9	298689	Gasket	1
10	298690	Cover, Bearing	1
11	298641	Gasket, Cover	1
12	N/A	Bolt	8
13	N/A	Washer, Spring	8
14	N/A	Washer, Plain	8
15	N/A	Bolt	8
16	298692	Washer, Cover 1	1
17	298693	Washer, Cover 2	2
18	298694	Washer, Cover 3	1
19	298695	Seal, Oil	1
20	298696	Assy. Case, Bearing 1	1
21	N/A	Case, Bearing 1-1	1
22	N/A	Case, Bearing 1-2	1
23	N/A	Assy. Case, Bearing 2	1
24	N/A	Case, Bearing 2-1	1

MAIN BEARING CASE GROUP

FROM SERIAL NO. 315023

TO

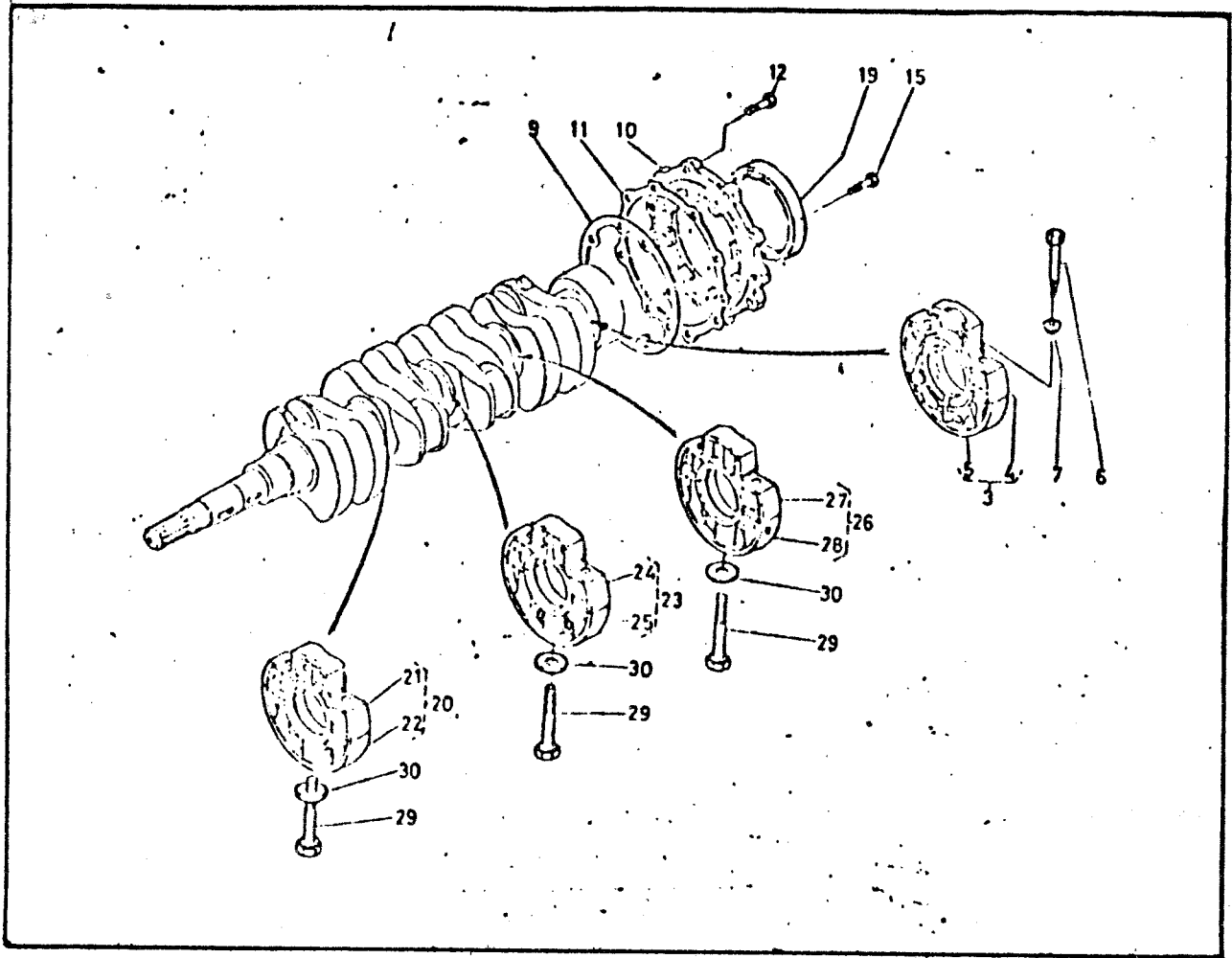

ITEM	PART NO.	DESCRIPTION	UNIT
1			
2			
3	298685	Assembly Case, Main Bearing	1
4	N/A	Case, Main Bearing/order by no. 3	1
5	N/A	Case, Main Bearing/order by no. 3	1
6	298686	Bolt 1	8
7	298687	Washer 1	8
8			
9	298689	Gasket	1
10	298690	Cover, Bearing	1
11	298641	Gasket, Cover	1
12	N/A	Bolt	8
13			
14			
15	N/A	Bolt	8
16			
17			
18			
19	298695	Seal, Oil	1
20	298696	Assembly Case, Bearing 1	1
21	N/A	Case, Bearing 1-1 /order by no. 20	1
22	N/A	Case, Bearing 1-2 /order by no. 20	1
23	N/A	Assembly Case, Bearing 2	1

BEARING CASE GROUP

Prior to Serial No. 315023

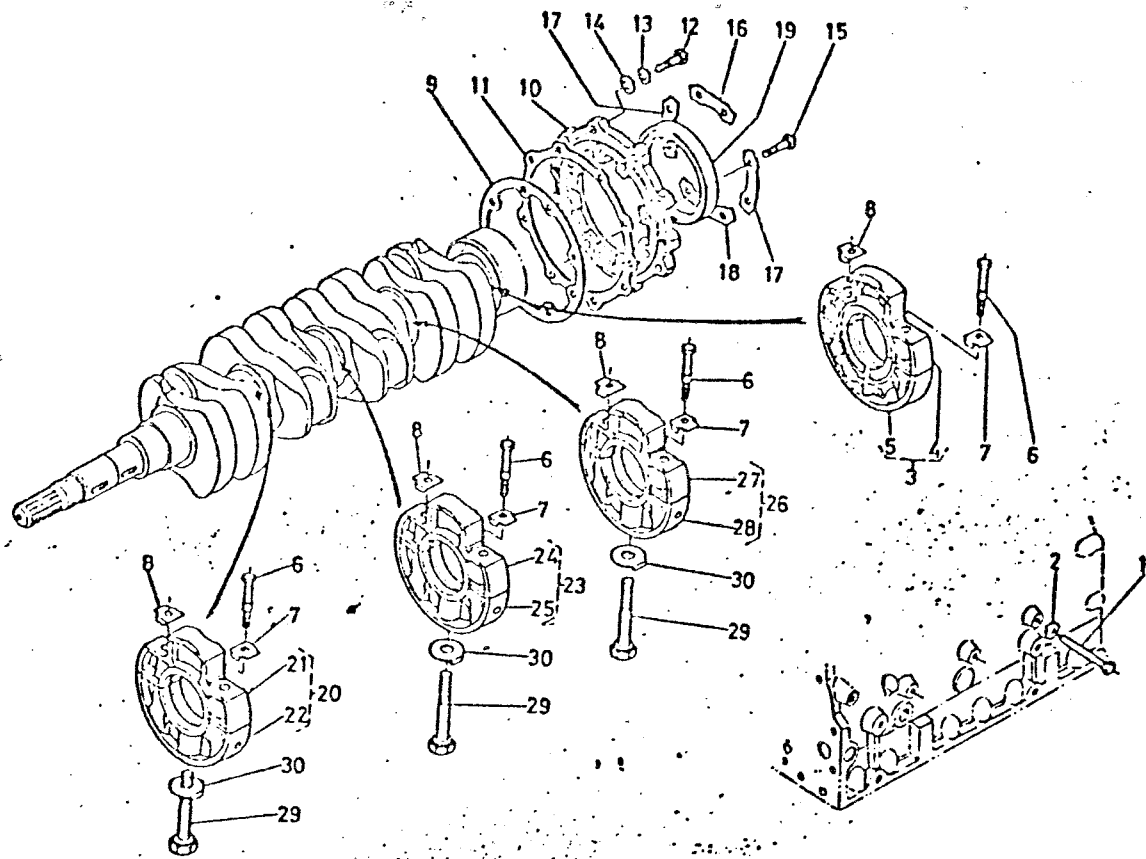

FROM SERIAL NO. 230101 TO 230125
315000 315022

ITEM	PART NO.	DESCRIPTION	UNIT
25	N/A	Case, Bearing 2-2	1
26	N/A	Assy. Case, Main Bearing	1
27	N/A	Case, Bearing 3-1	1
28	N/A	Case, Bearing 3-2	1
29	298697	Bolt 2	3
30	298698	Washer 3	3
31			
32			
33			
34			
35			
36			
37			
38			
39			
40			
41			
42			
43			
44			
45			
46			
47			
48			

MAIN BEARING CASE GROUP

FROM SERIAL NO. 315023 TO

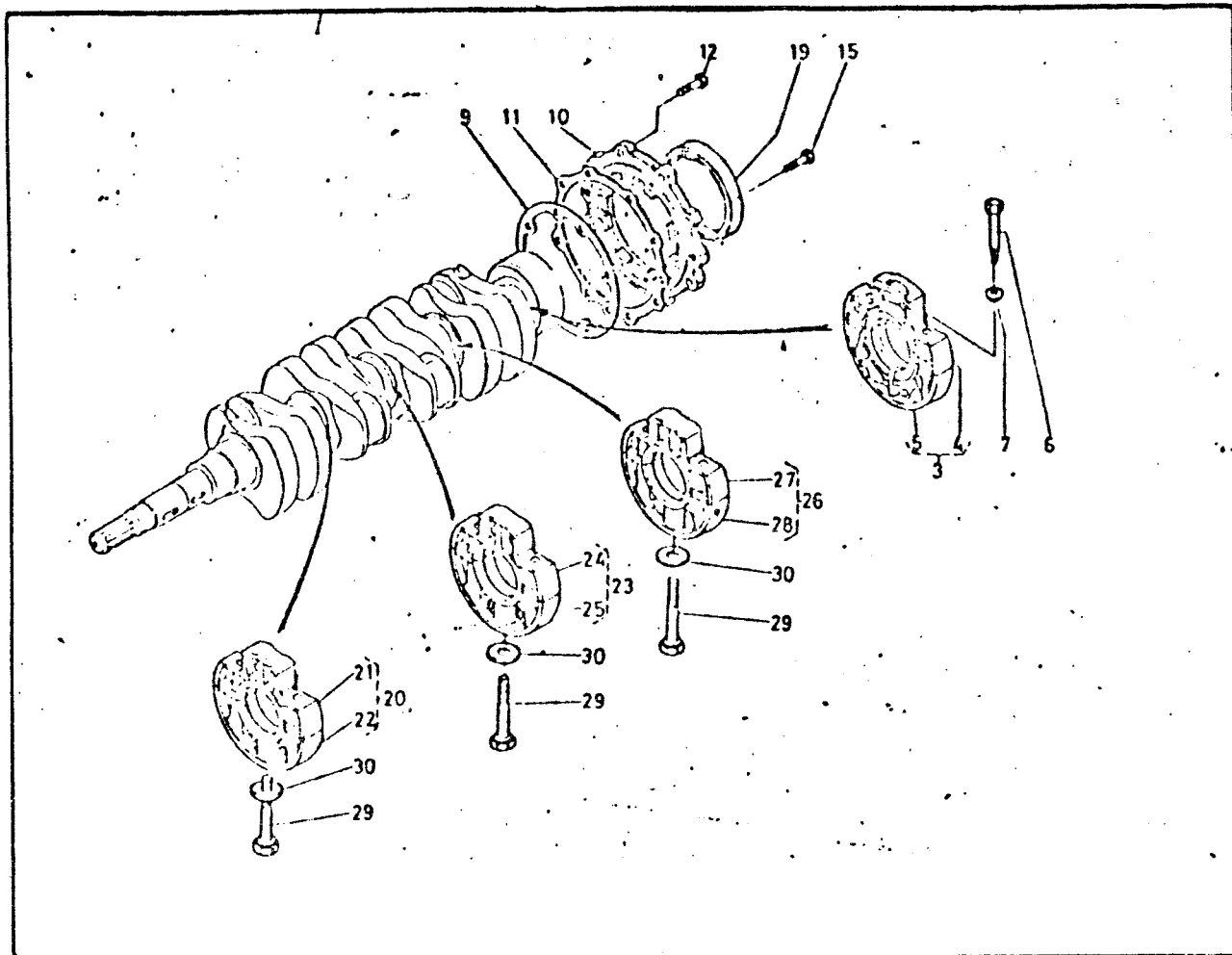

ITEM	PART NO.	DESCRIPTION	UNIT
24 . . .	N/A . . .	Case, Bearing 2-1 / order by no. 23 . . .	1
25 . . .	N/A . . .	Case, Bearing 2-2 / order by no. 23 . . .	1
26 . . .	N/A . . .	Assembly Case, Main Bearing . . .	1
27 . . .	N/A . . .	Case, Bearing 3-1 / order by no. 26 . . .	1
28 . . .	N/A . . .	Case, Bearing 3-2 / order by no. 26 . . .	1
29 . . .	298697 . . .	Bolt 2 . . .	3
30 . . .	298698 . . .	Washer, Plain . . .	3

HEAD COVER GROUP

Prior to Serial No. 315023

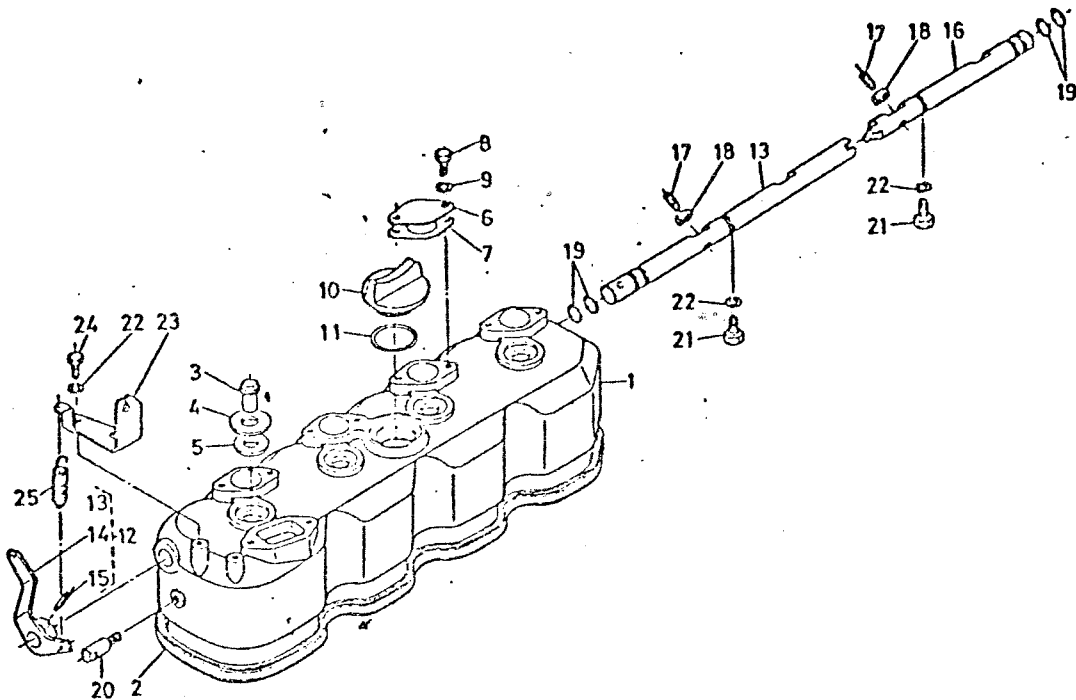

FROM SERIAL NO. 230101 315000 TO 230125 315022

ITEM	PART NO.	DESCRIPTION	UNIT
1	299569	Cover, Cylinder Head	1
2	299570	Gasket, Head Cover	1
3	298726	Nut, Head Cover	4
4	298727	Washer, Head Cover	4
5	298728	Gasket, Nut	4
6	298729	Cover, Decompression Hole	4
7	298730	Gasket	4
8	N/A	Bolt	8
9	N/A	Washer, Spring	8
10	298739	Plug, Oil Filler	1
11	298740	O Ring	1
12	299571	Assy. Shaft, Decompression	1
13	N/A	Shaft, Decompression	1
14	N/A	Lever, Decompression	1
15	N/A	Pin, Spring	1
16	N/A	Shaft, Decompression	1
17	298736	Bolt, Decompression	4
18	298737	Nut	4
19	298738	O Ring	4
20	298731	Stopper, Decompression Shaft	1
21	298732	Bolt	2
22	N/A	Washer, Spring	4
23	298733	Holder, Decompression Wire	1
24	N/A	Bolt	2
25	298764	Spring, Decompression	1

HEAD COVER GROUP

FROM SERIAL NO. 315023 TO

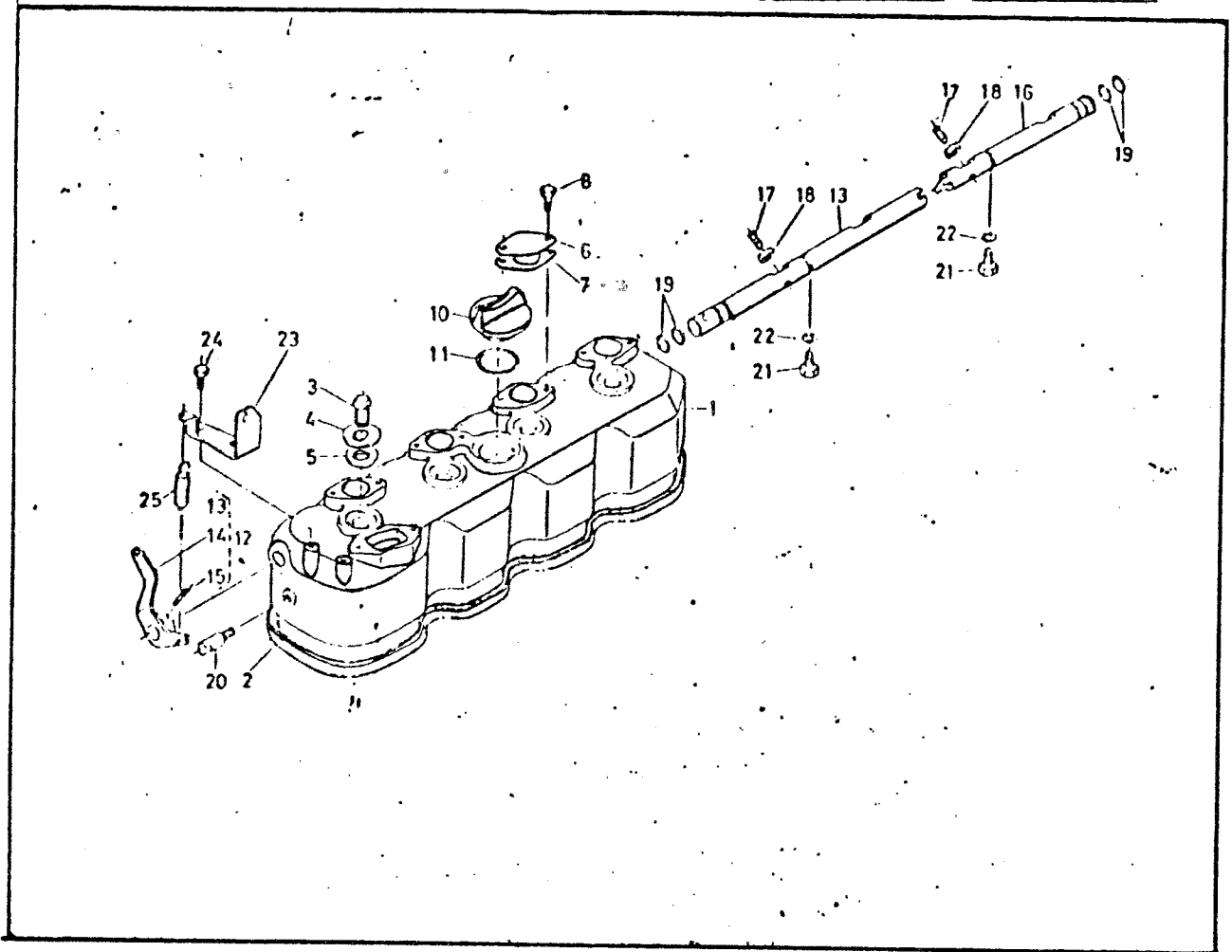

ITEM	PART NO.	DESCRIPTION	UNIT
1	299569	Cover, Cylinder Head	1
2	299570	Gasket, Head Cover	1
3	299726	Nut, Head Cover	4
4	298727	Washer, Head Cover	4
5	298728	Gasket, Nut	4
6	298729	Cover, Decompression Hole	4
7	298730	Gasket	4
8	N/A	Bolt	8
9			
10	298739	Plug, Oil Filler	1
11	298740	O Ring	1
12	299571	Assembly Shaft, Decompression	1
13	N/A	Shaft, Decompression/order by no. 12	1
14	N/A	Lever Decompression/order by no. 12	1
15	N/A	Pin, Spring	1
16	N/A	Shaft, Decompression	1
17	298736	Bolt, Decompression	4
18	298737	Nut	4
19	298738	O Ring	4
20	298731	Stopper, Decompression Shaft	1
21	298732	Bolt	2
22	N/A	Washer, Spring	2
23	298733	Holder, Decompression Wire	1

HEAD COVER GROUP

FROM SERIAL NO. 315023 TO

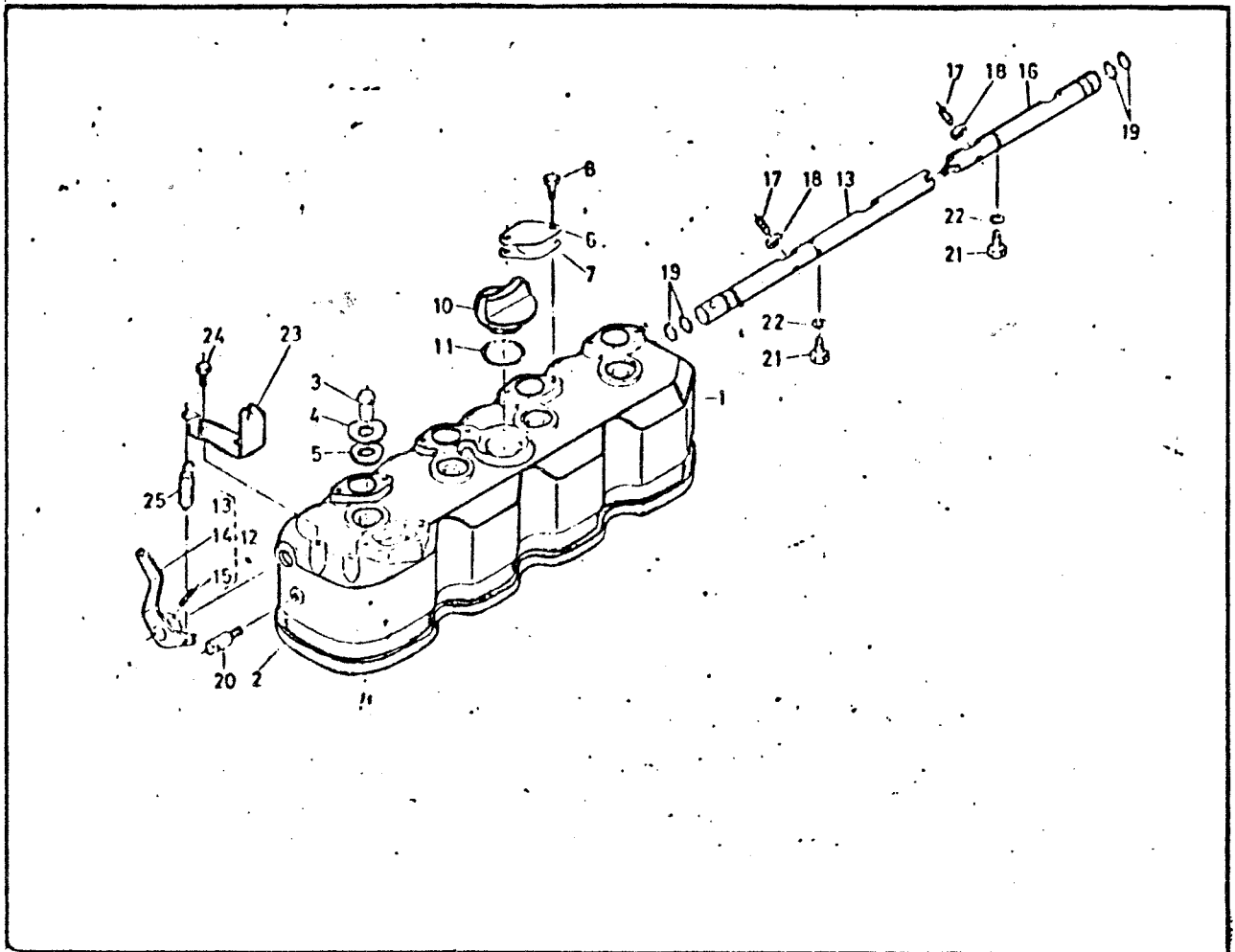

<u>ITEM</u>	<u>PART NO.</u>	<u>DESCRIPTION</u>	<u>UNIT</u>
24 . . .	N/A . . .	Bolt	2
25 . . .	299471 . . .	Spring, Decompression	1

BREATHER GROUP

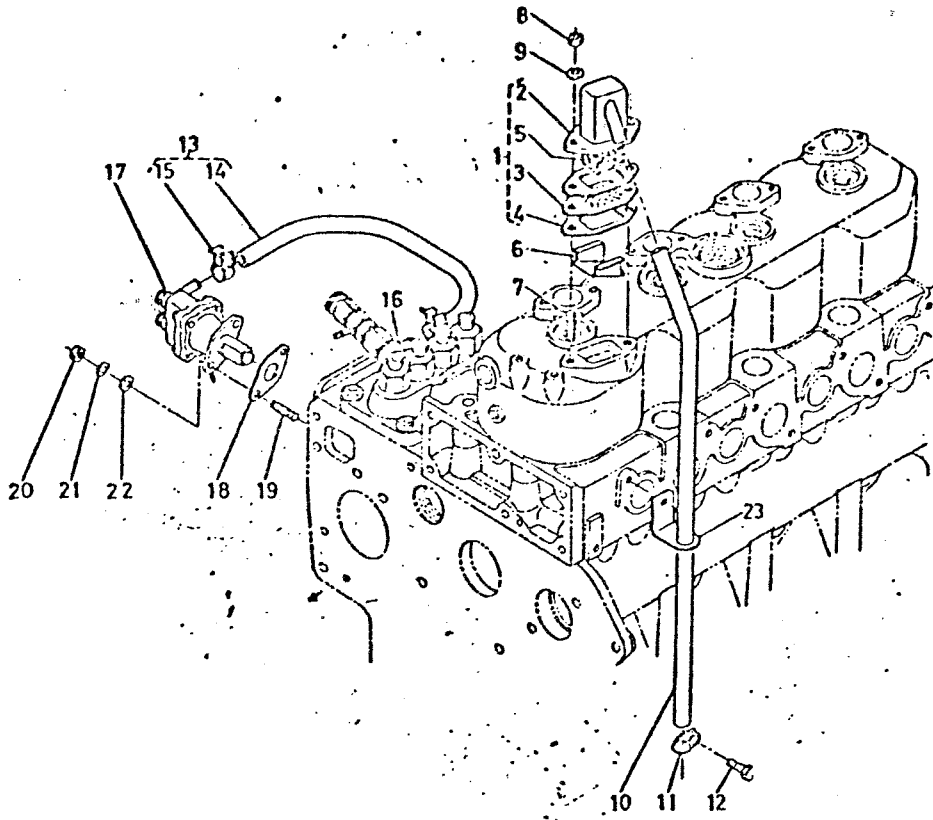

ITEM	PART NO.	DESCRIPTION	UNIT
1	N/A	Assy. Breather	1
2	298699	Breather	1
3	298700	Plate, Element	1
4	298701	Gasket	2
5	298702	Element, Breather	1
6	298703	Oil Shield, Breather	1
7	N/A	Stud	2
8	N/A	Nut	2
9	N/A	Washer, Spring	2
10	298704	Hose, Breather	1
11	N/A	Clamp, Pipe	1
12	N/A	Bolt	1
13	N/A	Assy. Pipe, Fuel	1
14	N/A	Pipe, Fuel	1
15	N/A	Clip, Pipe	2
16	N/A	Joint, Eye	1
17	299425	Assy. Pump, Fuel	1
18	299426	Gasket, Fuel Pump	1
19	N/A	Stud	2
20	N/A	Nut	2
21	N/A	Washer, Spring	2
22	N/A	Washer, Plain	2
23	N/A	Clamp, Pipe	1
24			

CAMSHAFT GROUP

Prior to Serial No. 315023

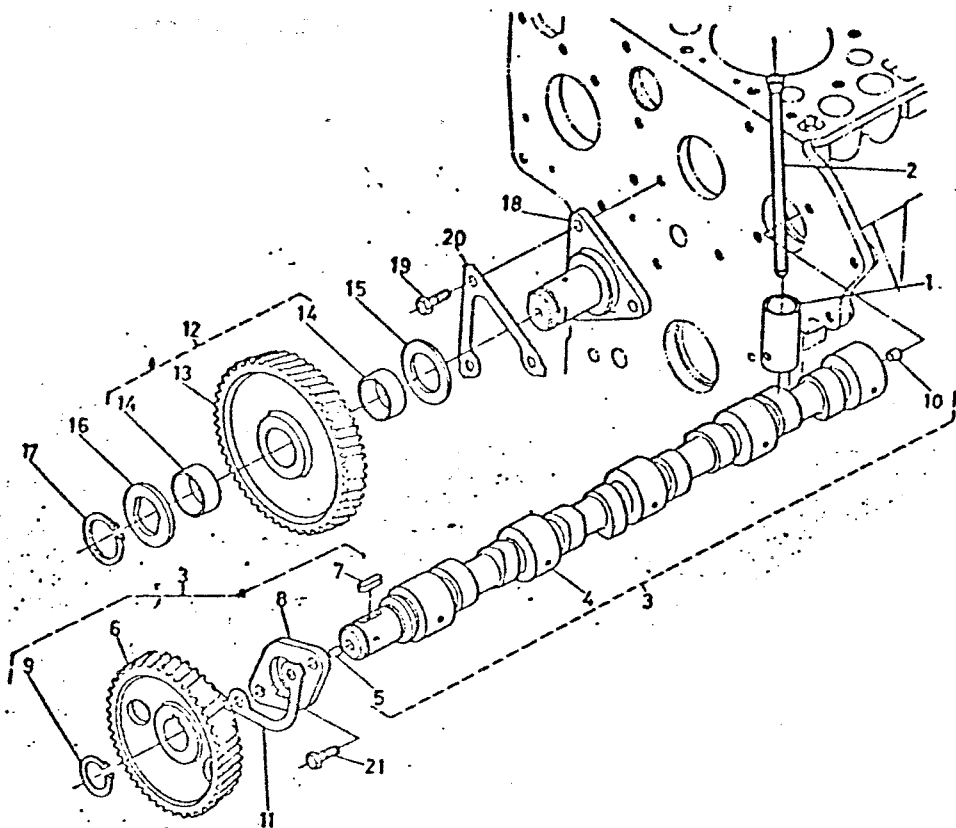

FROM SERIAL NO. 230101 TO 230125
315000 315022

ITEM	PART NO.	DESCRIPTION	UNIT
1	298741	Tappet	8
2	298742	Rod, Push	8
3	299572	Assy. Camshaft	1
4	N/A	Camshaft	1
5	298744	Plug, Pin	1
6	298745	Gear, Camshaft	1
7	298746	Key, Feather	1
8	298747	Stopper, Camshaft	1
9	298748	Cir-Clip, External	1
10	N/A	Plug, Pin	1
11	298741	Washer, Stopper	1
12	298750	Assy. Gear, Idle	1
13	N/A	Gear, Idle	1
14	N/A	Bush, Idle Gear	1
15	298751	Collar, Idle Gear	2
16	298752	Collar, Idle Gear	1
17	298753	Cir-Clip, External	1
18	298754	Shaft, Idle Gear	1
19	N/A	Bolt	1
20	298755	Washer, Idle Gear Shaft	3
21	N/A	Bolt	1
22			2
23			
24			

CAMSHAFT GROUP

FROM SERIAL NO. 315023 TO

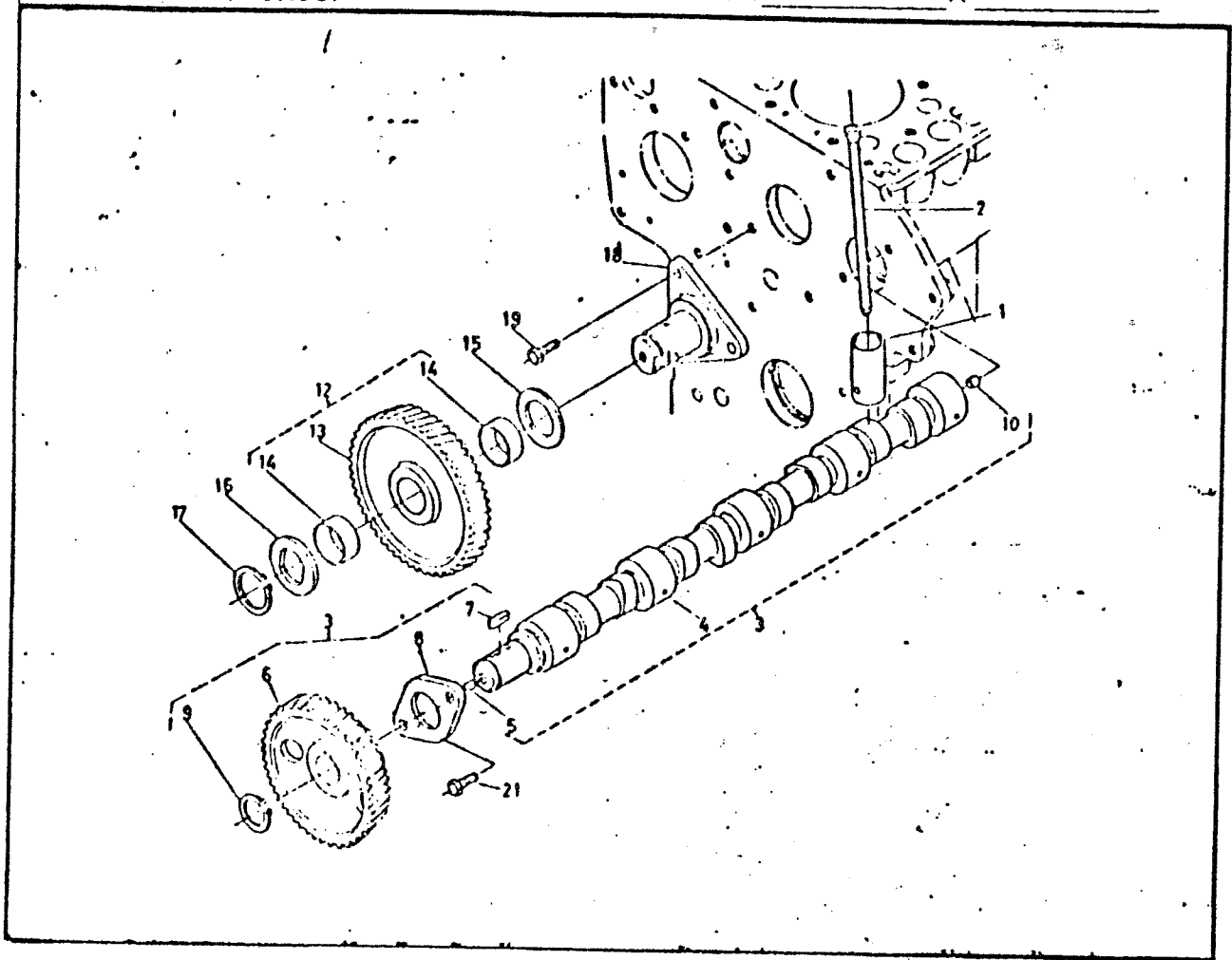

<u>ITEM</u>	<u>PART NO.</u>	<u>DESCRIPTION</u>	<u>UNIT</u>
1 . . .	298741 . . .	Tappet	8
2 . . .	298742 . . .	Rod, Push	8
3 . . .	299572 . . .	Assembly, Camshaft	1
4 . . .	N/A . . .	Camshaft/order by no. 3	1
5 . . .	298744 . . .	Plug, Pin	1
6 . . .	298745 . . .	Gear, Camshaft	1
7 . . .	298746 . . .	Key, Feather	1
8 . . .	298747 . . .	Stopper, Camshaft	1
9 . . .	298748 . . .	Cir-Clip, External	1
10 . . .	N/A . . .	Plug, Pin	1
11 . . .			
12 . . .	298750 . . .	Assembly Gear, Idle	1
13 . . .	N/A . . .	Gear, Idle/order by no. 12	1
14 . . .	N/A . . .	Bush, Idle Gear	2
15 . . .	298571 . . .	Collar, Idle Gear	1
16 . . .	298572 . . .	Collar, Idle Gear	1
17 . . .	298573 . . .	Cir-Clip External	1
18 . . .	298574 . . .	Shaft, Idle Gear	1
19 . . .	N/A . . .	Bolt	3
20 . . .			
21 . . .	N/A . . .	Bolt	2

VALVE ROCKER ARM GROUP

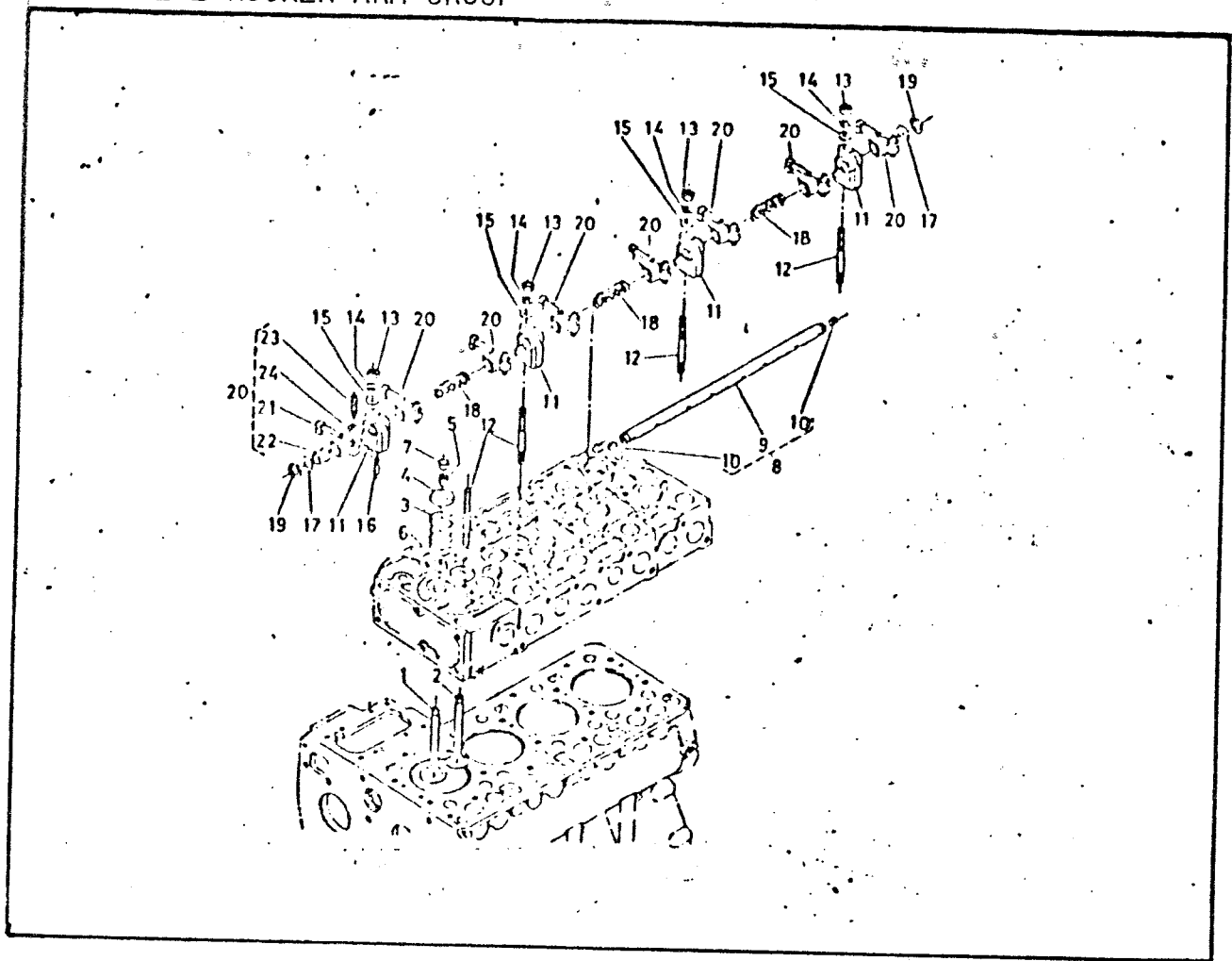

ITEM	PART NO.	DESCRIPTION	UNIT
1 . . .	298709	Valve, Inlet	4
2 . . .	298710	Valve, Exhaust	4
3 . . .	298711	Spring, Valve	8
4 . . .	298712	Retainer, Valve Spring	8
5 . . .	298713	Collet, Valve Spring	16
6 . . .	298714	Seal, Valve Stem	8
7 . . .	298715	Cap, Valve	8
8 . . .	299566	Assembly Shaft, Rocker Arm	1
9 . . .	N/A	Shaft, Rocker Arm/order by no. 8	1
10 . . .	298719	Screw, Set	2
11 . . .	298717	Bracket, Rocker Arm	4
12 . . .	298718	Stud	4
13 . . .	N/A	Nut	4
14 . . .	N/A	Washer, Spring	4
15 . . .	N/A	Washer, Plain	4
16 . . .	N/A	Screw, Set	1
17 . . .	298720	Washer	2
18 . . .	298721	Spring, Rocker Arm	3
19 . . .	298722	Cir-Clip, External	2
20 . . .	298723	Assembly Arm, Rocker	8
21 . . .	N/A	Rocker Arm/order by no. 20	1
22 . . .	N/A	Bush	1
23 . . .	N/A	Screw, Adjusting	1
24 . . .	N/A	Nut	1

PISTON, CRANKSHAFT GROUP

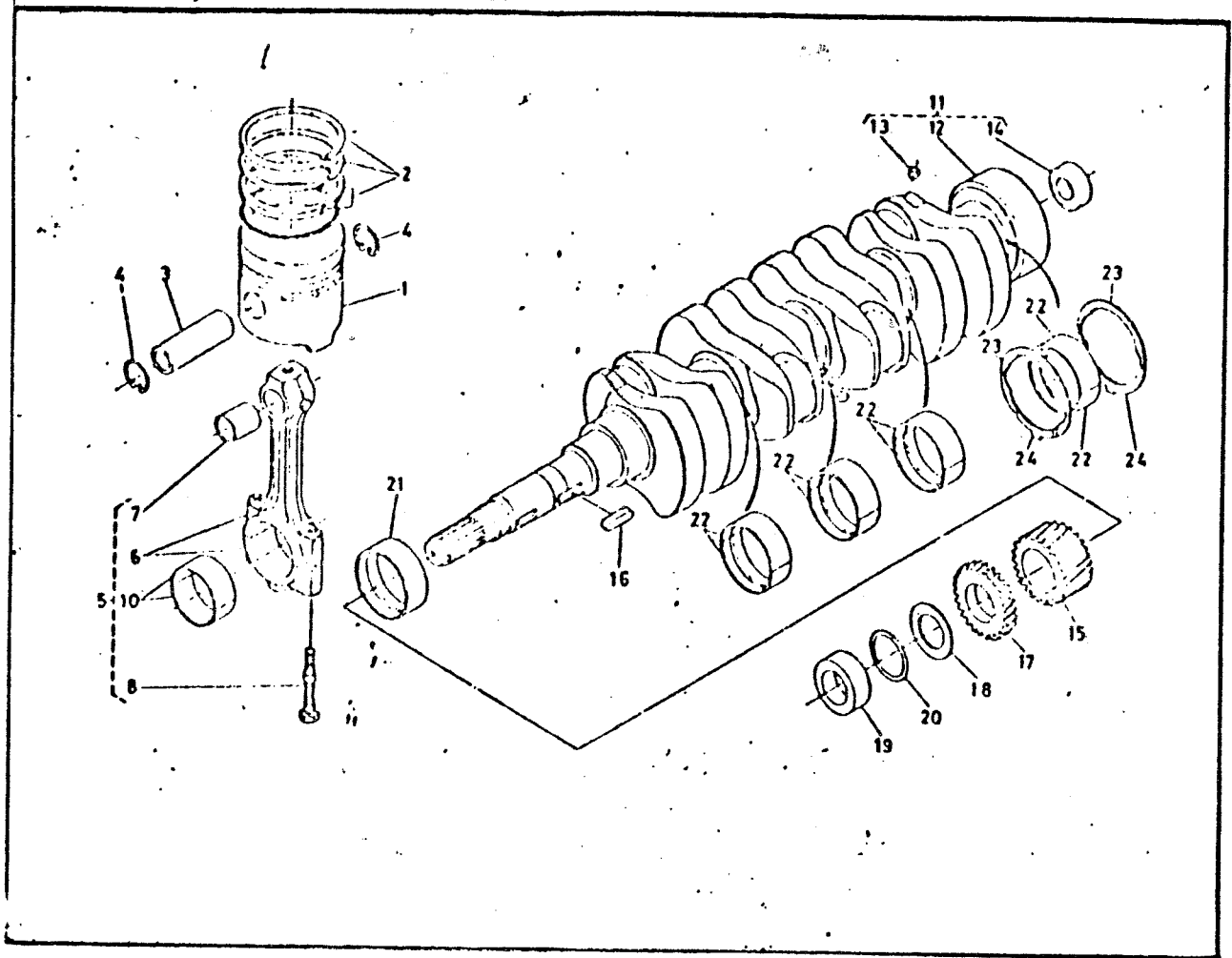

ITEM	PART NO.	DESCRIPTION	UNIT
1	298762	Piston	4
2	298763	Assembly Ring, Piston	4
3	298764	Pin, Piston	4
4	298765	Cir-Clip, Piston Pin	8
5	298766	Assembly Rod, Connecting	4
6	N/A	Connecting Rod/order by no. 5	1
7	N/A	Bush, Piston Pin	1
8	N/A	Bolt, Connecting Rod	2
9			
10	298767	Metal, Crank Pin	2
11	299573	Assembly Shaft, Crank	1
12	N/A	Crankshaft/order by no. 11	1
13	N/A	Plug, Pin	4
14	N/A	Bearing, Ball	1
15	298568	Gear, Crankshaft	1
16	N/A	Key, Feather	1
17	N/A	Gear, Oil Pump Drive	1
18	N/A	Oil Slinger	1
19	298772	Collar, Crankshaft	1
20	298773	O Ring	1
21	298775	Main Bearing - Rear	1
22	298776	Main Bearing - Center & Front	8
23	298777	Main Bearing - Side & Top	2
24	298778	Main Bearing - Side & Bottom	2

FLYWHEEL GROUP

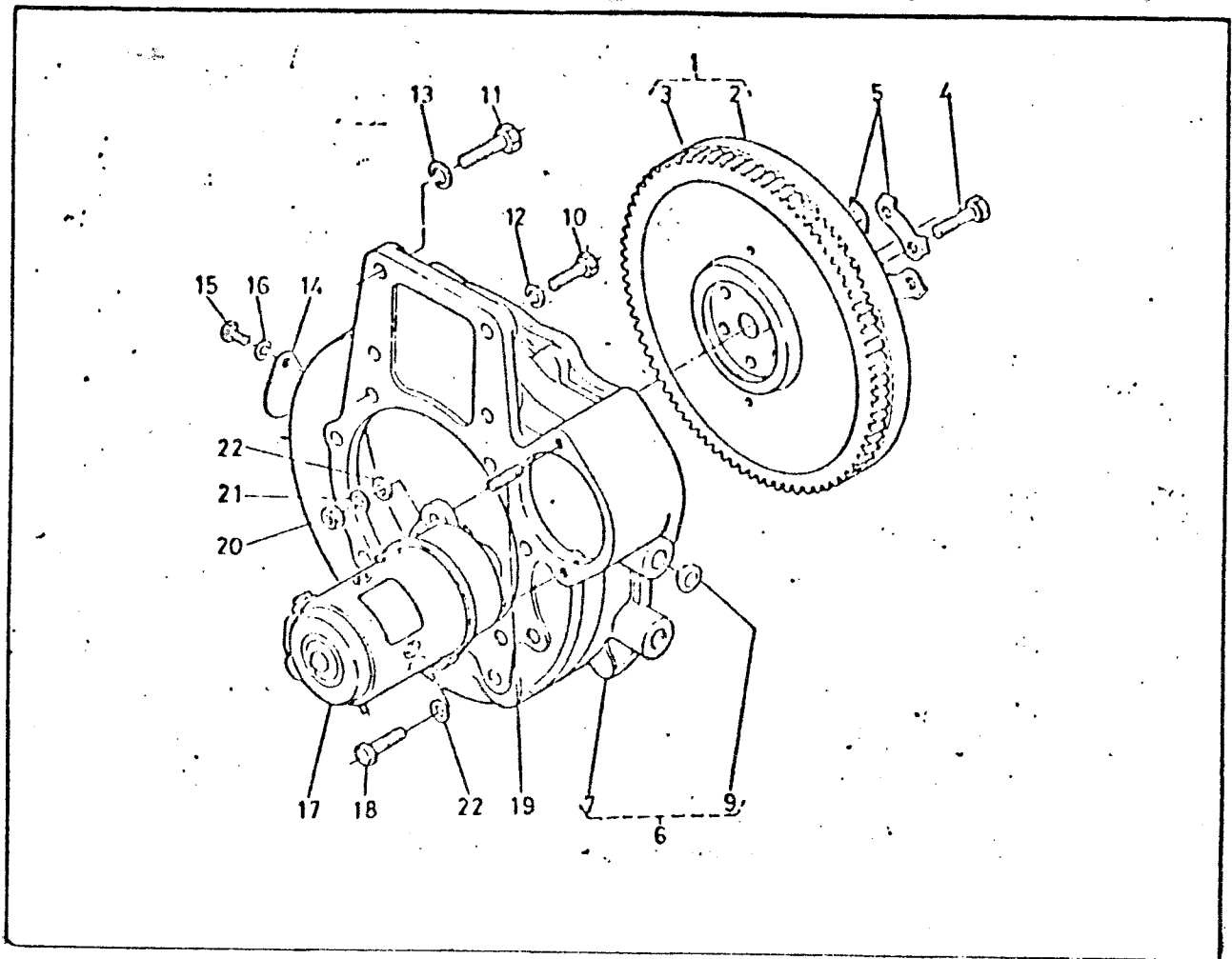

<u>ITEM</u>	<u>PART NO.</u>	<u>DESCRIPTION</u>	<u>UNIT</u>
1 . . .	299611 . . .	Assembly, Flywheel	1
2 . . .	N/A	Flywheel/order by no. 1	1
3 . . .	N/A	Gear, Ring	1
4 . . .	298780	Bolt, Flywheel	6
5 . . .	298781	Washer, Flywheel	3
6 . . .	298612	Assembly Housing, Flywheel	1
7 . . .	N/A	Housing, Flywheel/order by no. 6	1
8 . . .			
9 . . .	N/A	Plug	4
10 . . .	N/A	Bolt	11
11 . . .	N/A	Bolt	2
12 . . .	N/A	Washer, Spring	11
13 . . .	N/A	Washer, Spring	2
14 . . .	N/A	Cover	1
15 . . .	N/A	Bolt	1
16 . . .	N/A	Washer, Spring	1
17 . . .	299574	Assembly, Starter	1
18 . . .	N/A	Bolt	1
19 . . .	N/A	Stud	1
20 . . .	N/A	Nut	1
21 . . .	N/A	Washer, Spring	1
22 . . .	N/A	Washer, Plain	2
23 . . .	298458	Soc. Hd. Cap Scr.(5MM x .80P x 12MM Lg)	8

FLYWHEEL GROUP

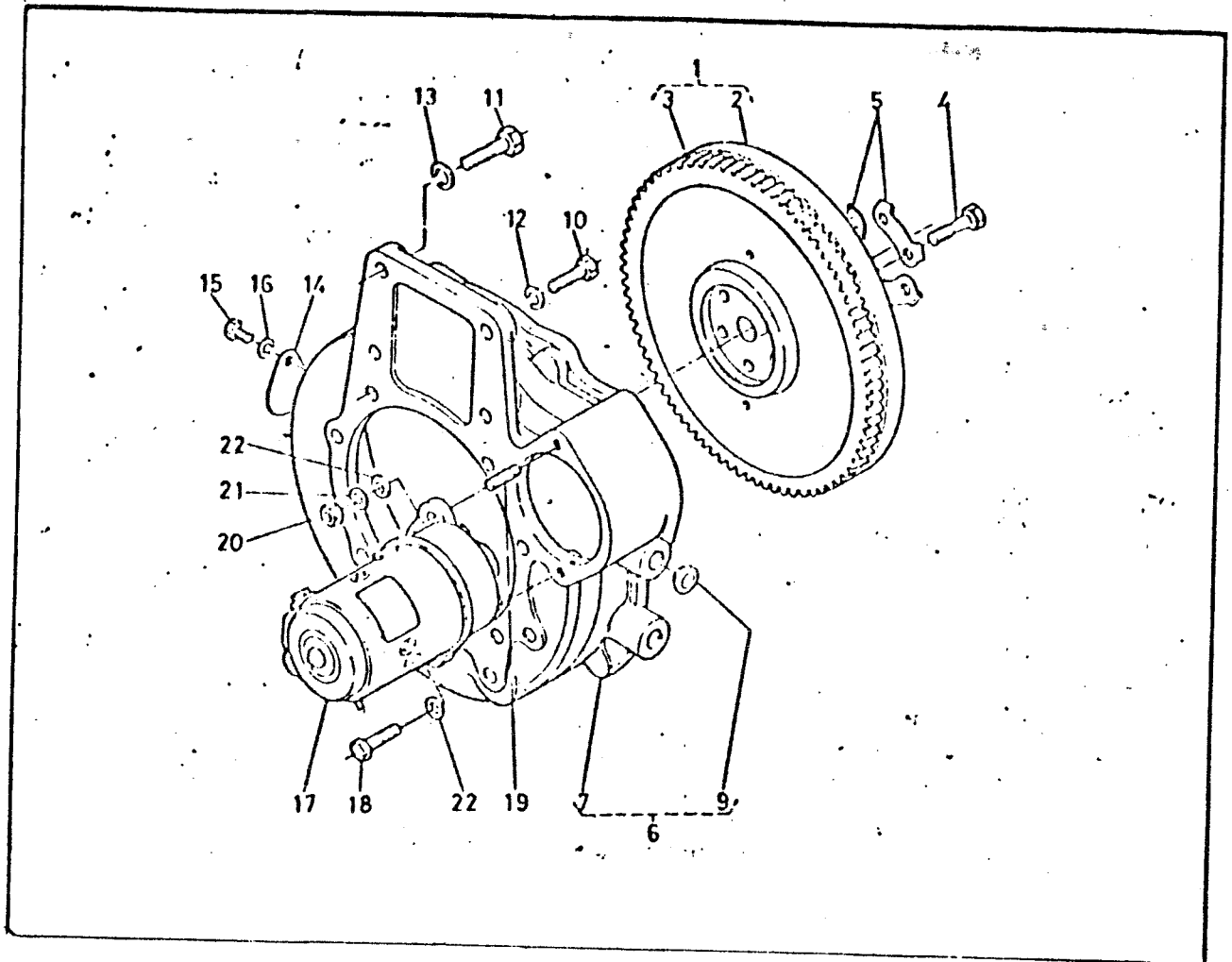

<u>ITEM</u>	<u>PART NO.</u>	<u>DESCRIPTION</u>	<u>UNIT</u>
24 . . .	298460 . . .	Soc. Hd. Cap Scr.(8MM x 1.25P x 25MM Lg)	4
25 . . .	298469 . . .	Soc. Hd. Cap Scr.(8MM x 1.25P x 30MM Lg)	2
26 . . .	298459 . . .	Lock Washer, Split (5MM Screw)	8
27 . . .	298461 . . .	Lock Washer, Split (8MM Screw)	6
28 . . .	298618 . . .	Bell Housing Dowel Pin	2
29 . . .	298505 . . .	Damper Plate Mounting N/S	1
30 . . .	298454 . . .	Damper - Reverse Gear N/S	1

NOZZLE HOLDER GROUP

Serial No. Prior to 315023

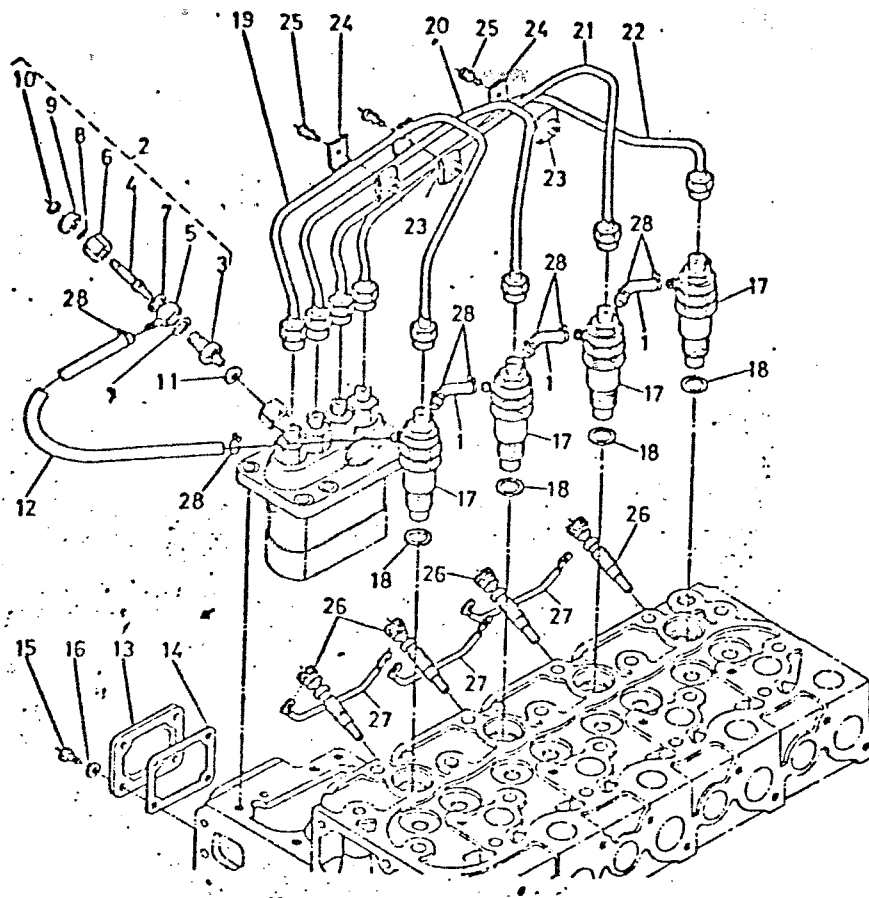

FROM SERIAL NO. 230101 TO 230125
315000 315022

ITEM	PART NO.	DESCRIPTION	UNIT
1	298784	Pipe, Fuel Over Flow	3
2	N/A	Assy. Cock	1
3	N/A	Body, Cock	1
4	N/A	Valve	1
5	N/A	Joint, Eye	1
6	N/A	Nut, Cap	1
7	N/A	Basket	2
8	N/A	O Ring	1
9	N/A	Knob	1
10	N/A	Nut	1
11	N/A	Gasket	1
12	N/A	Pipe, Fuel Over Flow	1
13	298785	Cover, Injection Pump	1
14	298786	Gasket, Pump Cover	1
15	N/A	Bolt	4
16	N/A	Washer, Spring	4
17	299518	Assy. Holder, Nozzle	4
18	298789	Gasket	4
19	298790	Pipe, Injection	1
20	298791	Pipe, Injection	1
21	298877	Pipe, Injection	1
22	299578	Pipe	1
23	298792	Clamp, Pipe	3
24	298793	Clamp, Pipe	3

NOZZLE HOLDER GROUP

FROM SERIAL NO. 315023 TO

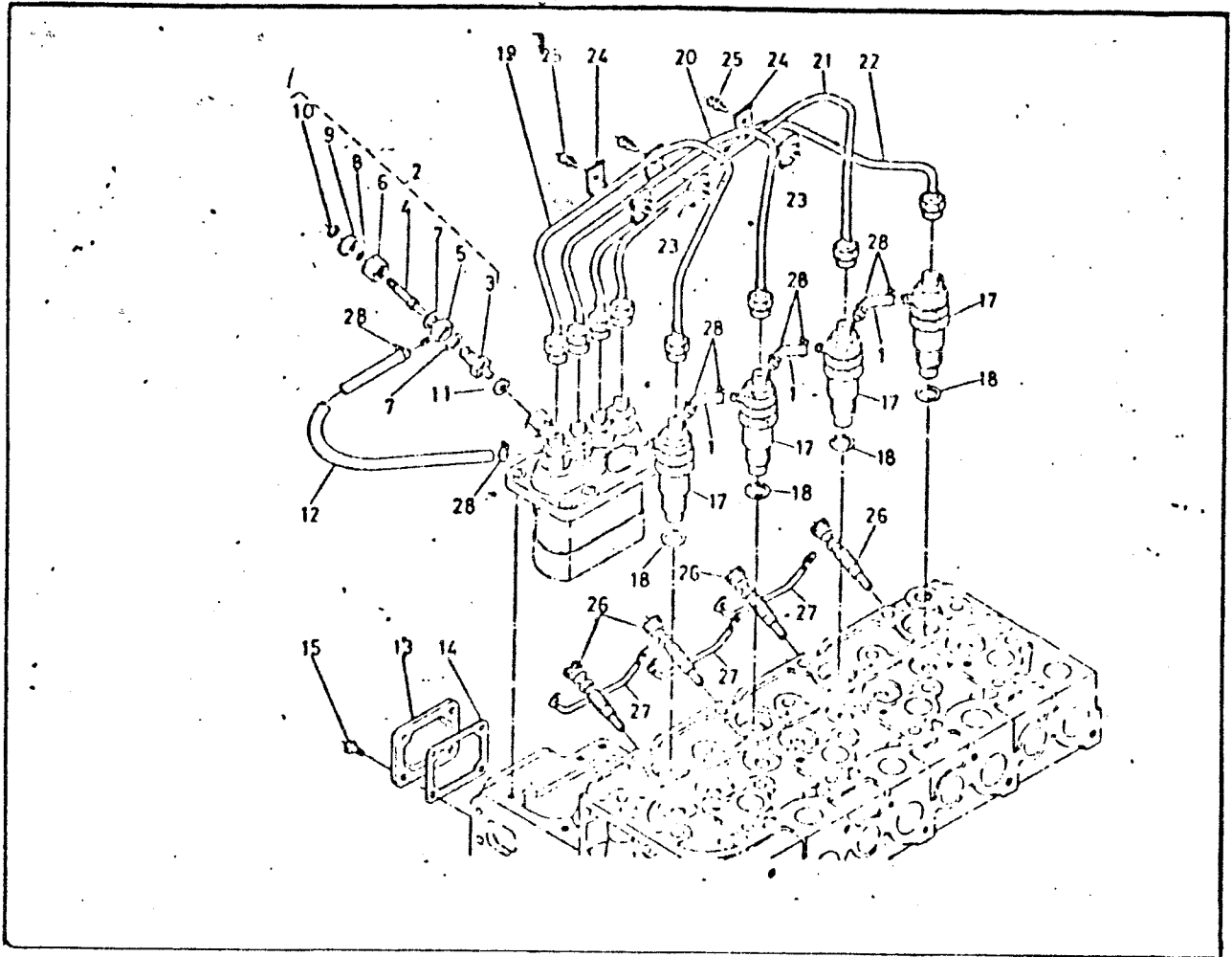

ITEM	PART NO.	DESCRIPTION	UNIT
1 . . .	298784 . . .	Pipe, Fuel Over Flow	3
2 . . .	299675 . . .	Assembly, Cock	1
3 . . .	N/A . . .	Body, Cock	1
4 . . .	N/A . . .	Valve	1
5 . . .	N/A . . .	Joint, Eye	1
6 . . .	N/A . . .	Nut, Cap	1
7 . . .	N/A . . .	Gasket	2
8 . . .	299677 . . .	O Ring	1
9 . . .	N/A . . .	Knob	1
10 . . .	N/A . . .	Nut	1
11 . . .	N/A . . .	Gasket	1
12 . . .	N/A . . .	Pipe, Fuel Over Flow	1
13 . . .	298785 . . .	Cover, Injection Pump	1
14 . . .	298786 . . .	Gasket, Pump Cover	1
15 . . .	N/A . . .	Bolt	4
16 . . .			
17 . . .	299567 . . .	Assembly, Holder Nozzle	4
18 . . .	298789 . . .	Gasket	4
19 . . .	298790 . . .	Pipe, Injection	1
20 . . .	298791 . . .	Pipe, Injection	1
21 . . .	298877 . . .	Pipe, Injection	1
22 . . .	299578 . . .	Pipe, Injection	1
23 . . .	298792 . . .	Clamp, Pipe	3
24 . . .	298793 . . .	Clamp, Pipe	3

NOZZLE HOLDER GROUP

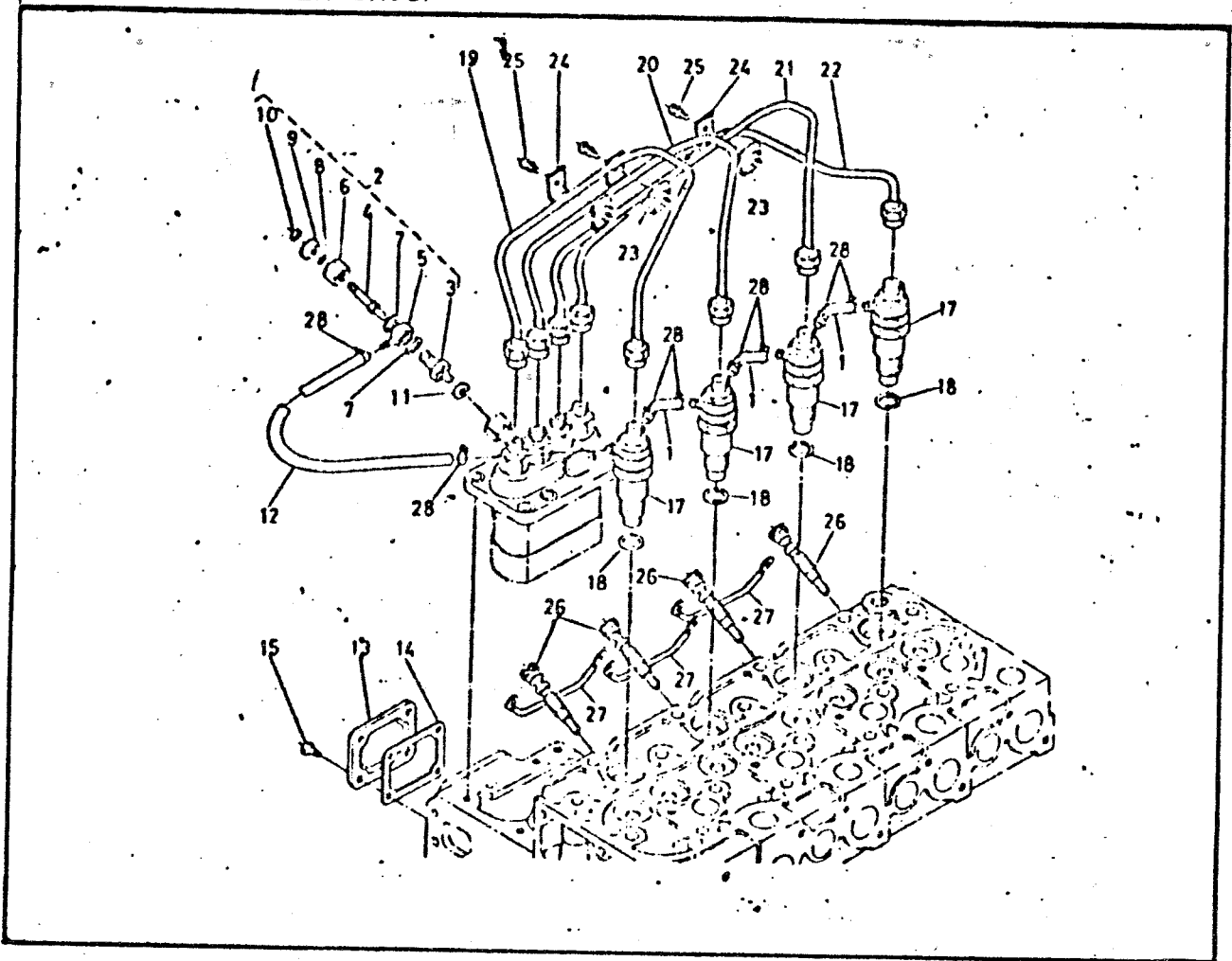

<u>ITEM</u>	<u>PART NO.</u>	<u>DESCRIPTION</u>	<u>UNIT</u>
25 . . .	298794 . . .	Screw, With Washer	3
26 . . .	298795 . . .	Plug, Glow	4
27 . . .	298796 . . .	Cord, Glow Plug	3
28 . . .	298797 . . .	Clip, Pipe	8

FUEL CAMSHAFT GROUP

Serial No. Prior to 315023

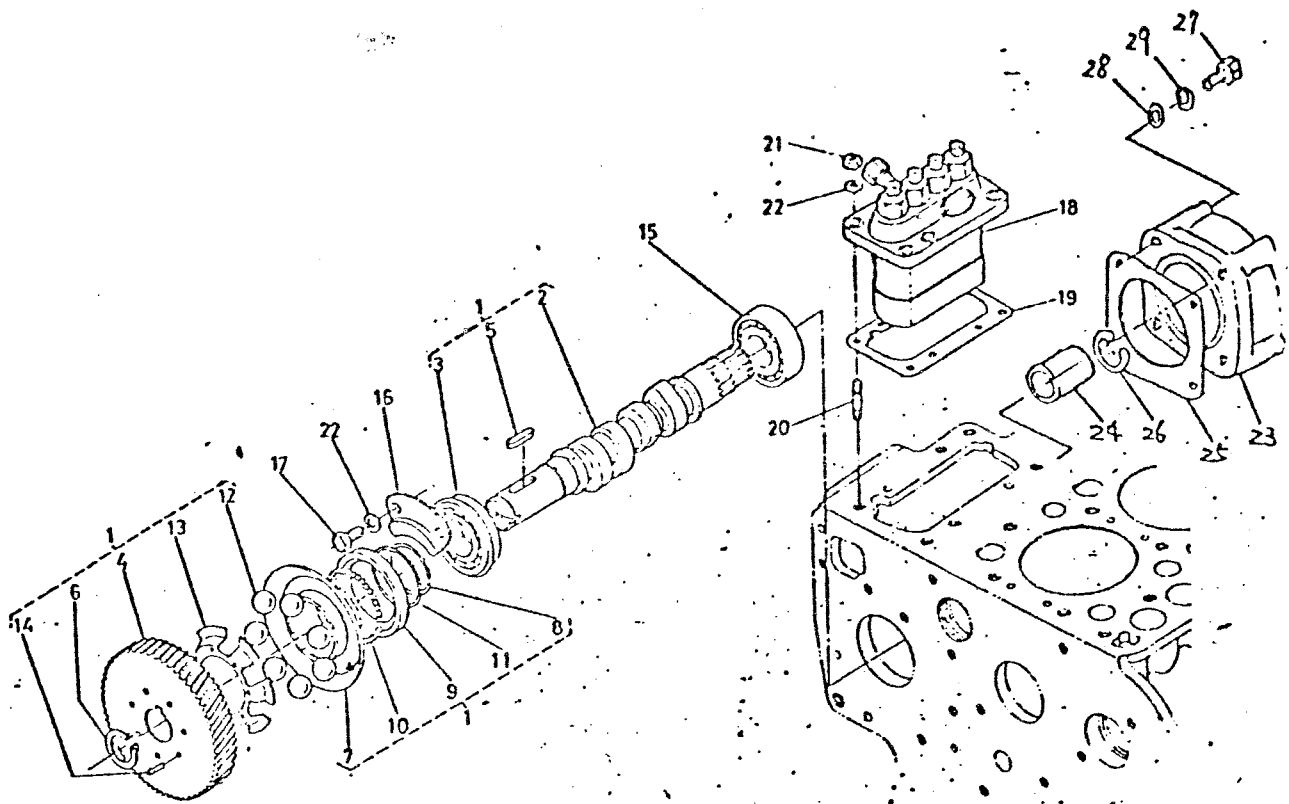

FROM SERIAL NO. 230101 TO 230125
315000 315022

ITEM	PART NO.	DESCRIPTION	UNIT
1	N/A	Assy. Camshaft, Fuel	1
2	299601	Camshaft, Fuel	1
3	298816	Bearing, Ball	1
4	299575	Gear, Injection Pump	1
5	298801	Key, Feather	1
6	298810	Cir-Clip, External	1
7	298802	Sleeve, Governor	1
8	298803	Cir-Clip	1
9	298804	Case, Governor Ball	1
10	298805	Ball	39
11	298806	Cir-Clip	1
12	299576	Ball	7
13	299577	Guide, Governor Ball	1
14	298809	Rivet	7
15	298811	Bearing, Ball	1
16	298812	Stopper, f-Camshaft	1
17	N/A	Bolt	2
18	299579	Assy. Pump, Injection	1
19	299580	Shim	5
20	N/A	Stud	6
21	N/A	Nut	6
22	N/A	Washer, Spring	8
23	298813	Cover	1
24	298815	Collar	1

FUEL CAMSHAFT GROUP

FROM SERIAL NO. 315023 TO

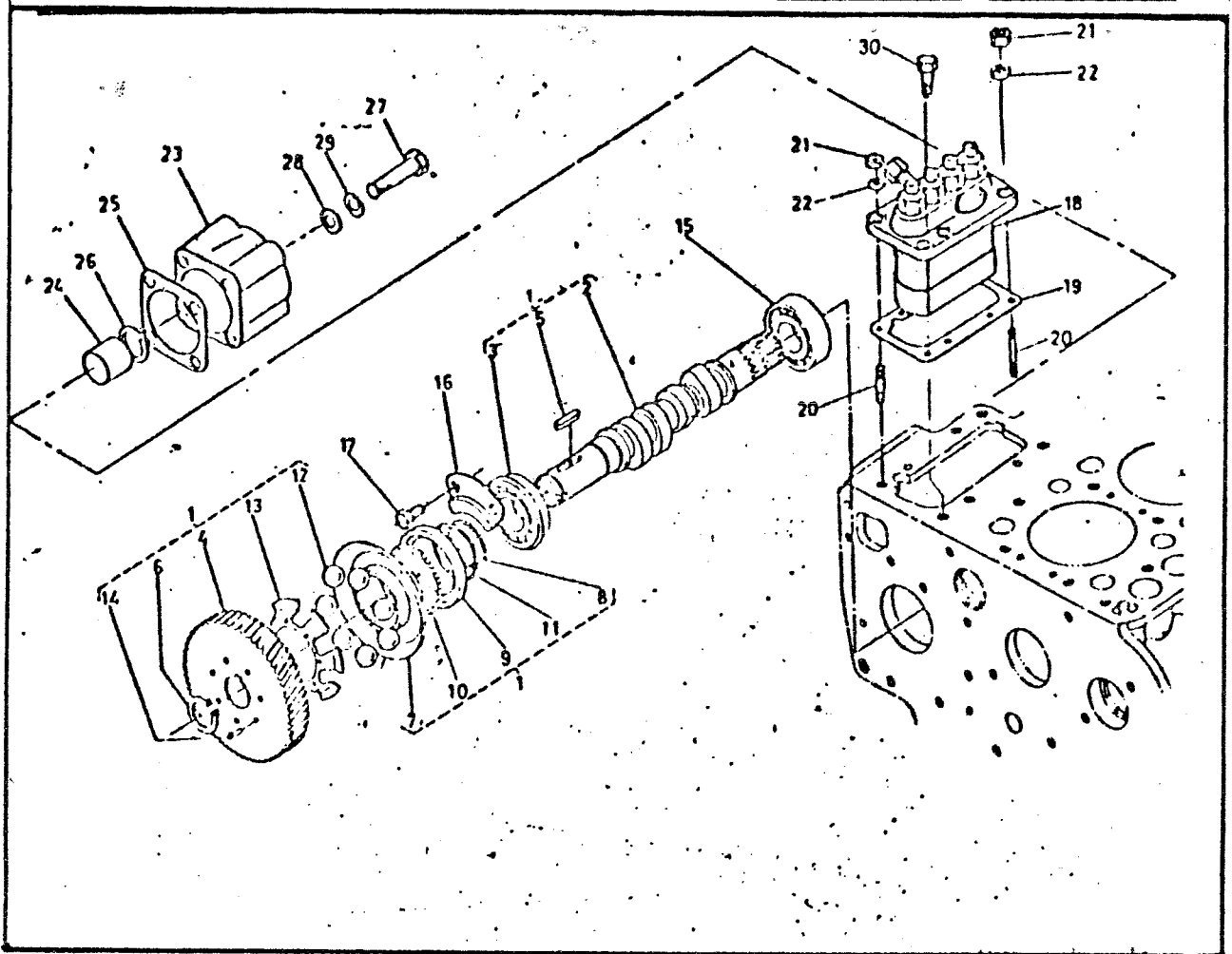

ITEM	PART NO.	DESCRIPTION	UNIT
1		Assembly Camshaft, Fuel	1
2	299601	Camshaft, Fuel	1
3	298816	Bearing, Ball	1
4	299575	Gear, Injection Pump	1
5	298801	Key, Feather	1
6	298810	Cir-Clip, External	1
7	298802	Sleeve, Governor	1
8	298803	Cir-Clip	1
9	298804	Case, Governor Ball	1
10	298805	Ball	39
11	298806	Cir-Clip	1
12	298576	Ball	7
13	299577	Guide, Governor Ball	1
14	298809	Rivet	7
15	298811	Bearing, Ball	1
16	298812	Stopper, f-Camshaft	1
17	N/A	Bolt	2
18	299579	Assembly Pump, Injection	1
19	299580	Shim	5
20	N/A	Stud	2
21	N/A	Nut	2
22	N/A	Washer, Spring	2
23	298813	Cover, Fuel Camshaft	1

FUEL CAMSHAFT GROUP

Serial No. Prior to 315023

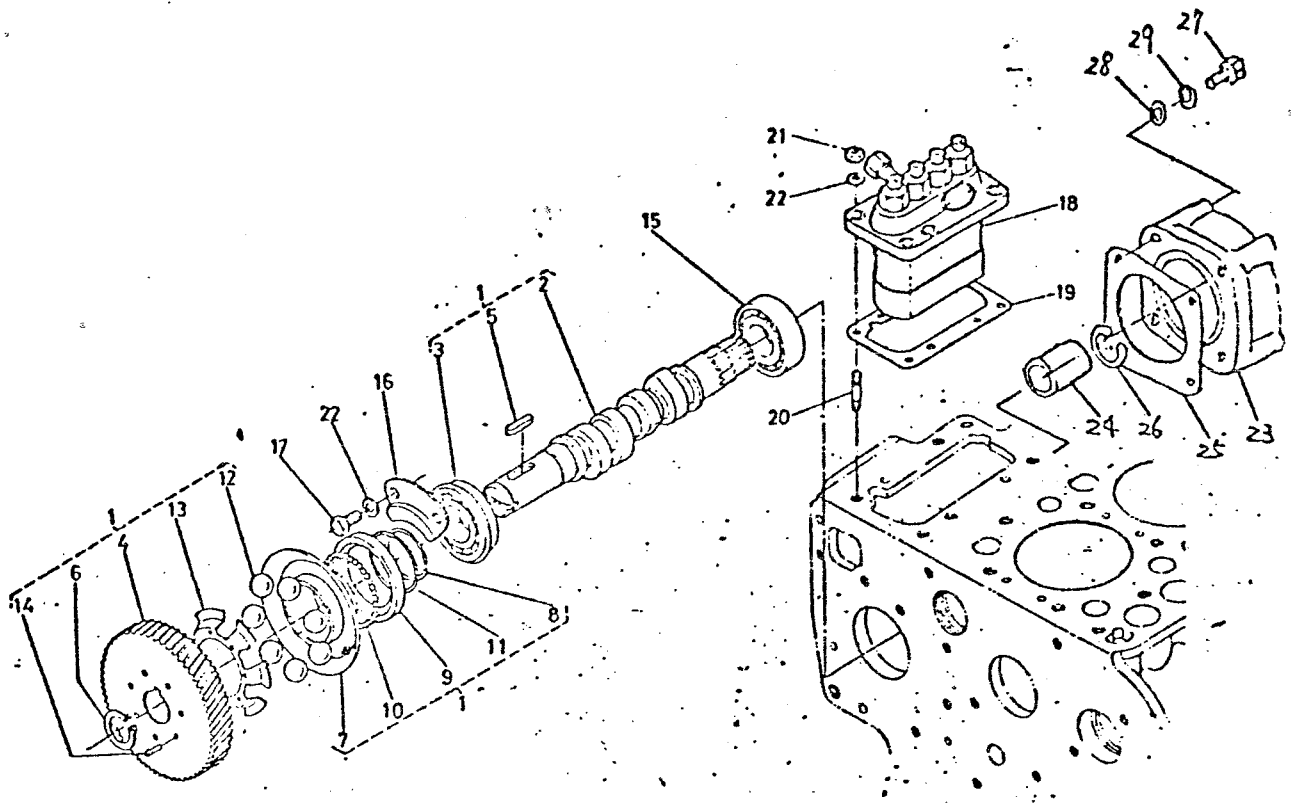

FROM SERIAL NO. 230101 315000 TO 230125 315022

ITEM	PART NO.	DESCRIPTION	UNIT
25	298814	Packing	1
26	298817	Cir-Clip, External	1
27	298581	Bolt	4
28	298582	Washer, Plain	4
29	298583	Washer, Spring	4
30			
31			
32			
33			
34			
35			
36			
37			
38			
39			
40			
41			
42			
43			
44			
45			
46			
47			
48			

FUEL CAMSHAFT GROUP

FROM SERIAL NO. 315023 TO

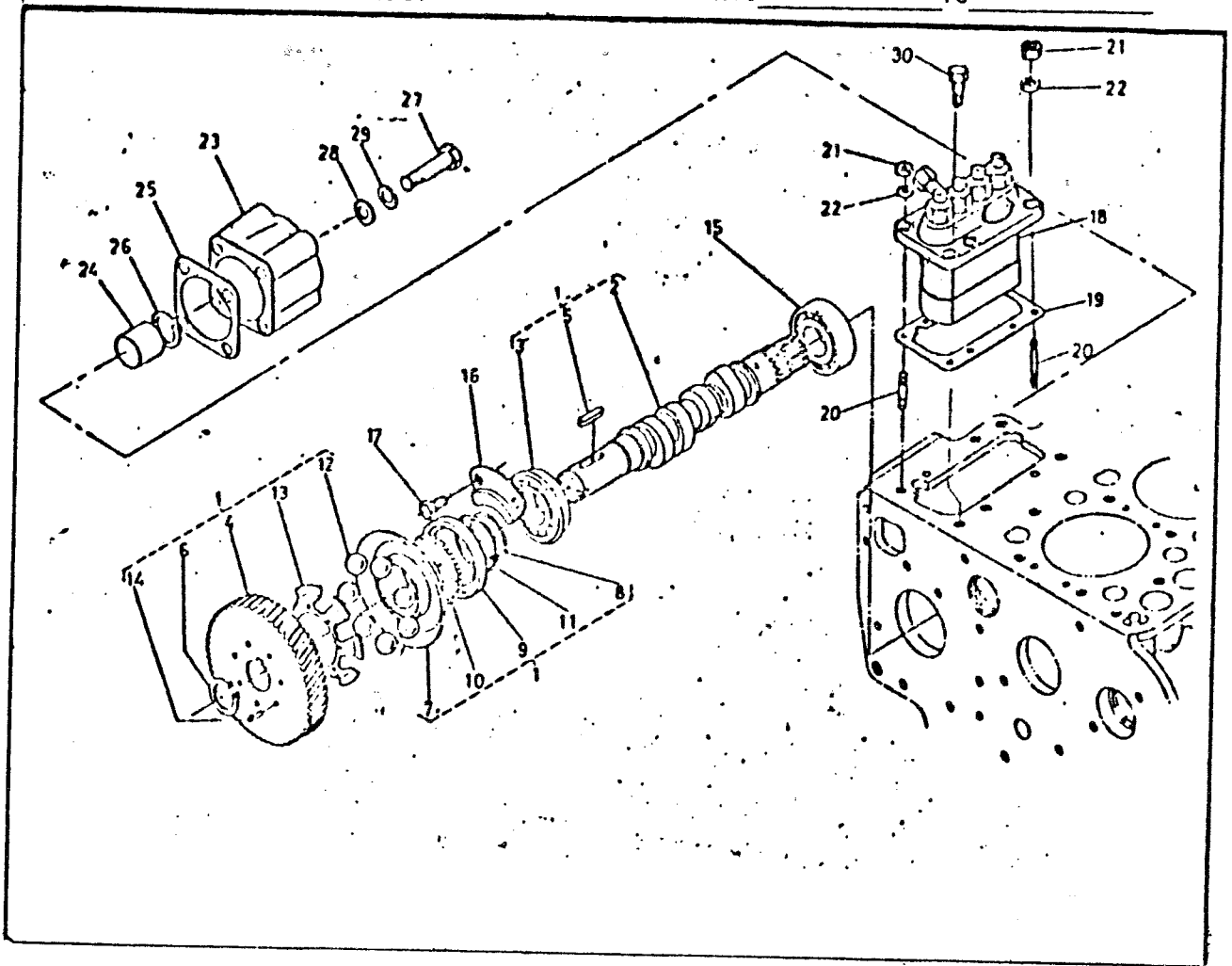

<u>ITEM</u>	<u>PART NO.</u>	<u>DESCRIPTION</u>	<u>UNIT</u>
24 . . .	298815	Collar	1
25 . . .	298814	Packing	1
26 . . .	298817	Cir-Clip, External	4
27 . . .	298581	Bolt	4
28 . . .	298582	Washer, Plain	4
29 . . .	298583	Washer, Spring	4
30 . . .	N/A	Bolt	4

SPEED CONTROL PLATE GROUP

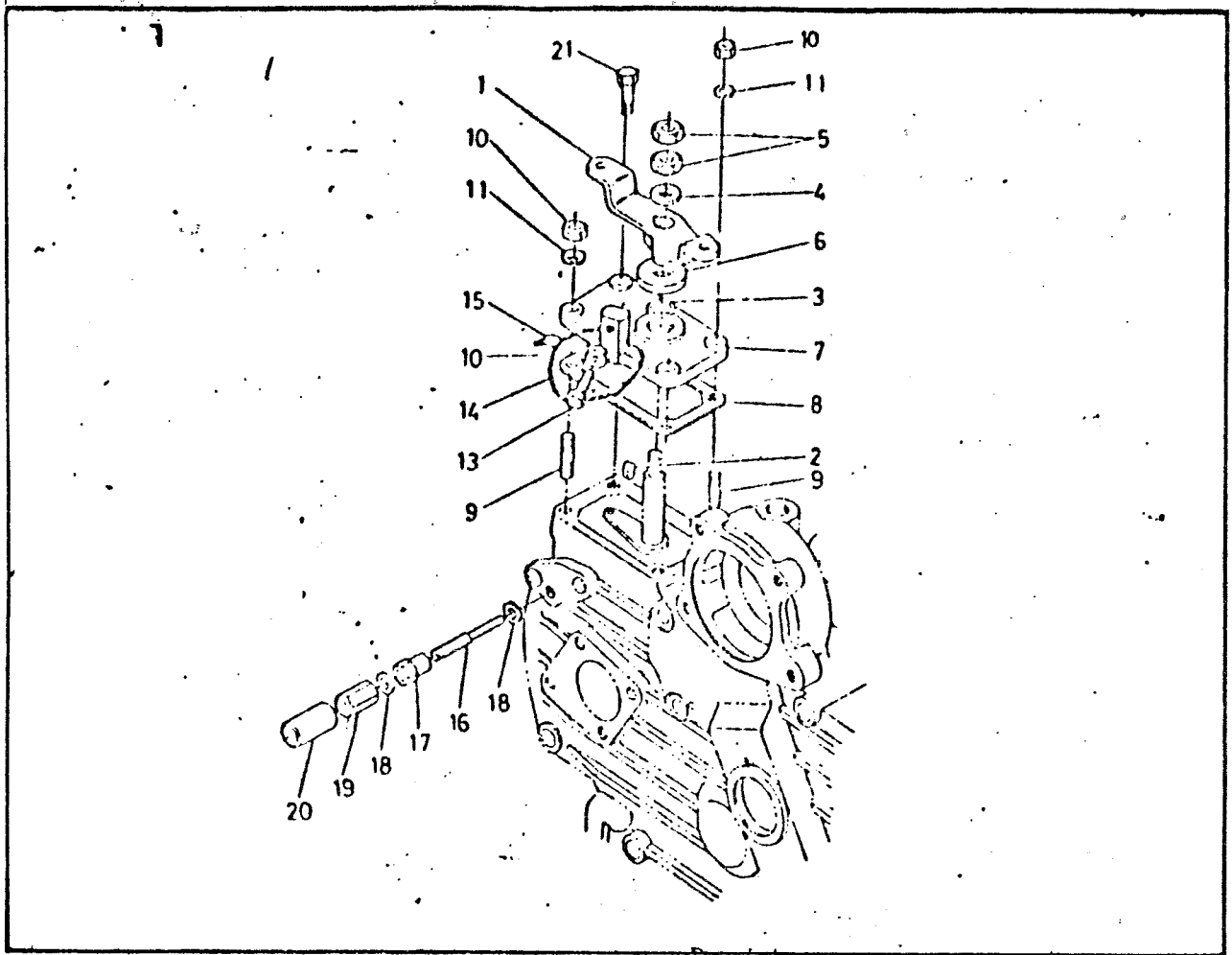

<u>ITEM</u>	<u>PART NO.</u>	<u>DESCRIPTION</u>	<u>UNIT</u>
1 . . .	299602 . . .	Lever, Speed Control	1
2 . . .	298820 . . .	Key, Feather	1
3 . . .	298821 . . .	O Ring	1
4 . . .	N/A . . .	Washer, Plain	1
5 . . .	N/A . . .	Nut	2
6 . . .	298822 . . .	Plate, Friction	1
7 . . .	298823 . . .	Plate, Speed Control	1
8 . . .	298824 . . .	Gasket, Control Plate	1
9 . . .	298825 . . .	Stud	2
10 . . .	N/A . . .	Nut	3
11 . . .	N/A . . .	Washer, Spring	2
12 . . .			
13 . . .	298826 . . .	Stopper	1
14 . . .	N/A . . .	Wire	1
15 . . .	N/A . . .	Lead, Sealing	1
16 . . .	N/A . . .	Bolt, Adjusting	1
17 . . .	N/A . . .	Nut	1
18 . . .	N/A . . .	Gasket	2
19 . . .	N/A . . .	Nut, Cap	1
20 . . .	N/A . . .	Cap	1
21 . . .	N/A . . .	Bolt	2

NOZZLE GROUP

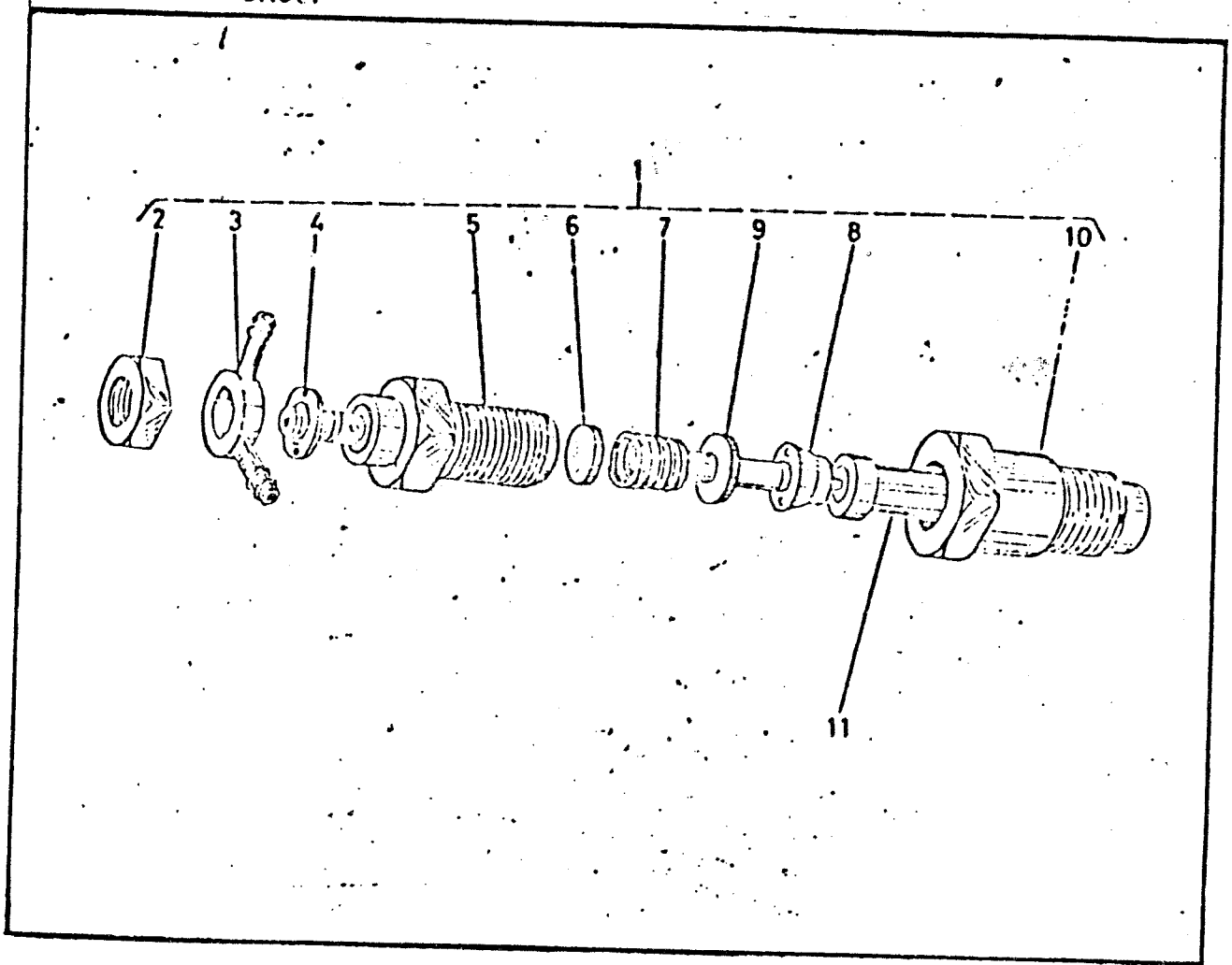

<u>ITEM</u>	<u>PART NO.</u>	<u>DESCRIPTION</u>	<u>UNIT</u>
1 . . .	N/A	Assembly Holder, Nozzle	1
2 . . .	N/A	Nut	1
3 . . .	N/A	Joint, Eye	1
4 . . .	N/A	Washer, Plain	1
5 . . .	N/A	Body, Nozzle Holder	1
6 . . .	N/A	Washer, Adjusting	1
7 . . .	N/A	Spring, Nozzle	1
8 . . .	N/A	Piece, Distance	1
9 . . .	N/A	Rod, Push	1
10 . . .	N/A	Nut, Nozzle	1
11 . . .	N/A	Piece, Nozzle	1

GOVERNOR GROUP

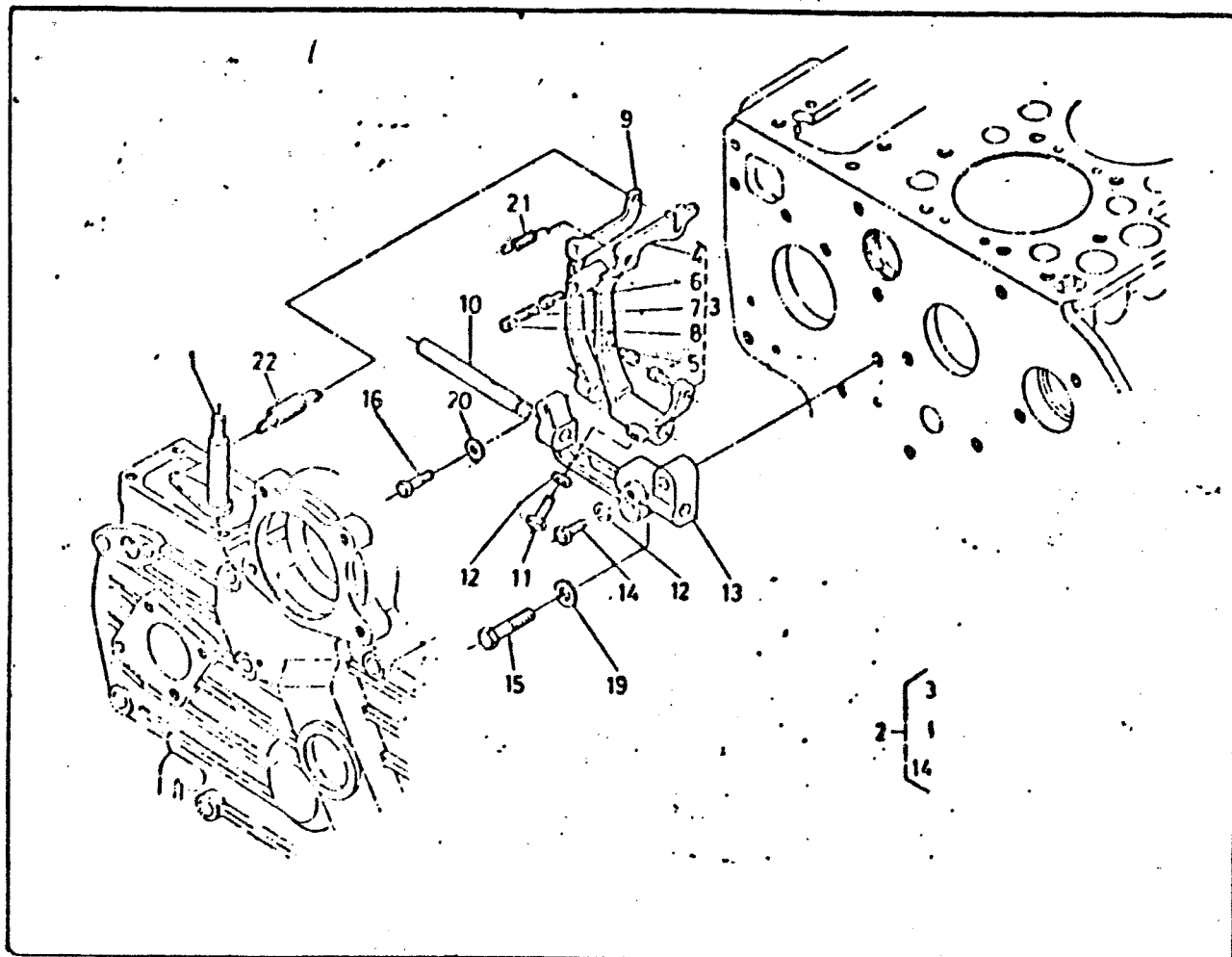

ITEM	PART NO.	DESCRIPTION	UNIT
1	N/A	Assembly Lever, Governor	1
2	N/A	Assembly Lever, Fork	1
3	298604	Assembly Lever, Fork	1
4	299605	Lever, Fork	1
5	N/A	Pin, Lever Fork	2
6	N/A	Pin, Lever Fork	1
7	298834	Spring	1
8	N/A	Screw, Set	1
9	N/A	Lever, Fork	1
10	298832	Shaft, Fork Lever	1
11	298833	Bolt	1
12	N/A	Washer, Spring	2
13	N/A	Holder, Fork Lever	1
14	298835	Bolt	1
15	N/A	Bolt	2
16	N/A	Bolt	1
17			
18			
19	N/A	Washer, Plain	2
20	N/A	Washer, Plain	1
21	298828	Spring, Start	1
22	299603	Spring, Governor	1

INJECTION PUMP GROUP

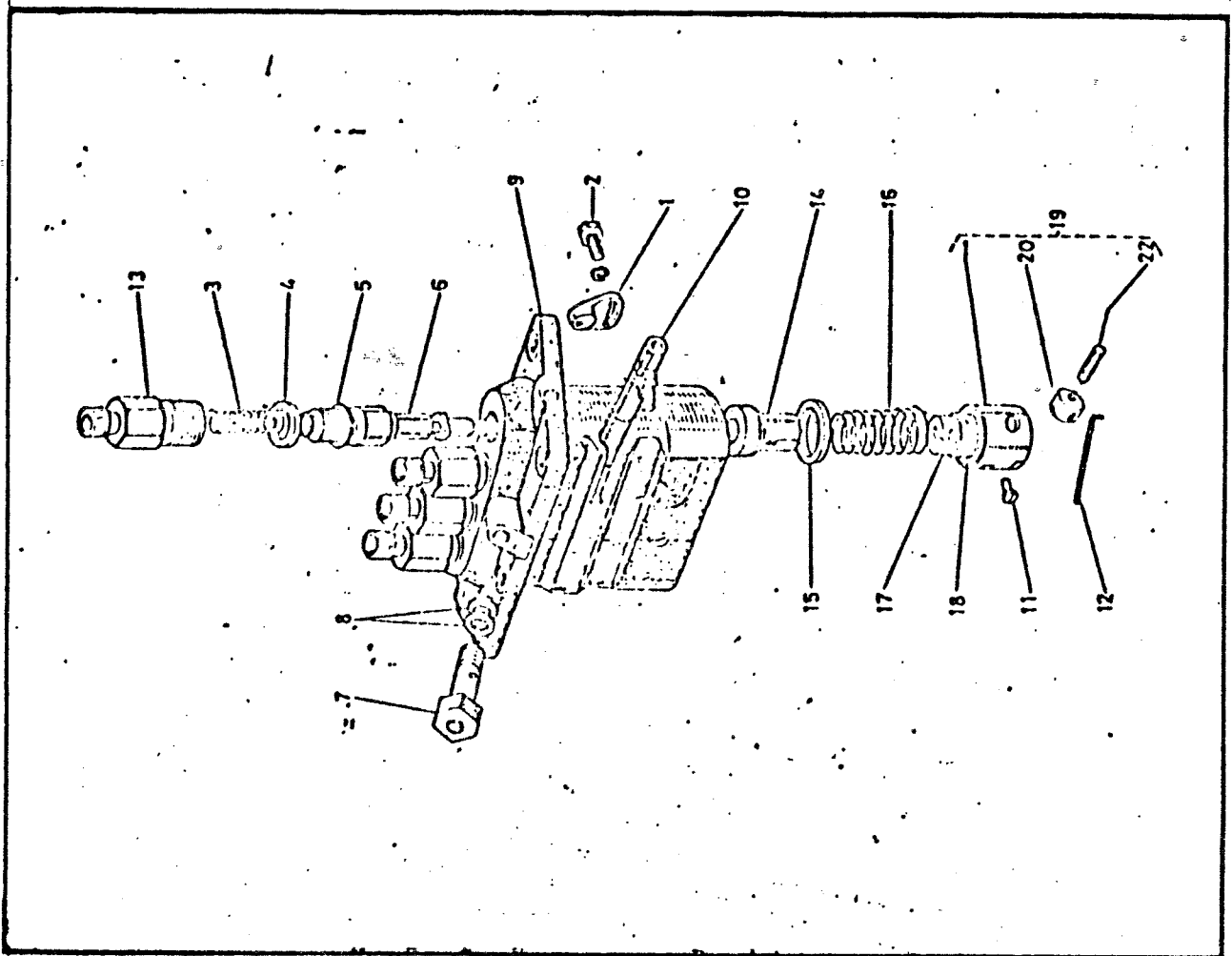

<u>ITEM</u>	<u>PART NO.</u>	<u>DESCRIPTION</u>	<u>UNIT</u>
1 . . .	N/A	Plate, Adjust	3
2 . . .	N/A	Bolt	3
3 . . .	N/A	Spring, Delivery Valve	4
4 . . .	N/A	Gasket, Delivery Valve	4
5 . . .	N/A	Valve, Delivery	4
6 . . .	N/A	Element, Pump	4
7 . . .	N/A	Screw	1
8 . . .	N/A	Gasket	2
9 . . .	N/A	Housing, Pump/order by no. 18	1
10 . . .	N/A	Rack, Control	1
11 . . .	N/A	Pin, Tappet Guide	4
12 . . .	N/A	Pin, Clamp	2
13 . . .	N/A	Holder, Delivery Valve	4
14 . . .	N/A	Sleeve, Control	4
15 . . .	N/A	Seat, Spring Upper	4
16 . . .	N/A	Spring, Plunger	4
17 . . .	N/A	Seat, Spring Under	4
18 . . .	N/A	Shim	4
19 . . .	N/A	Assembly, Tappet	4
20 . . .	N/A	Roller/order by no. 19	4
21 . . .			
22 . . .	N/A	Pin, Roller/order by no. 19	4

STARTER GROUP

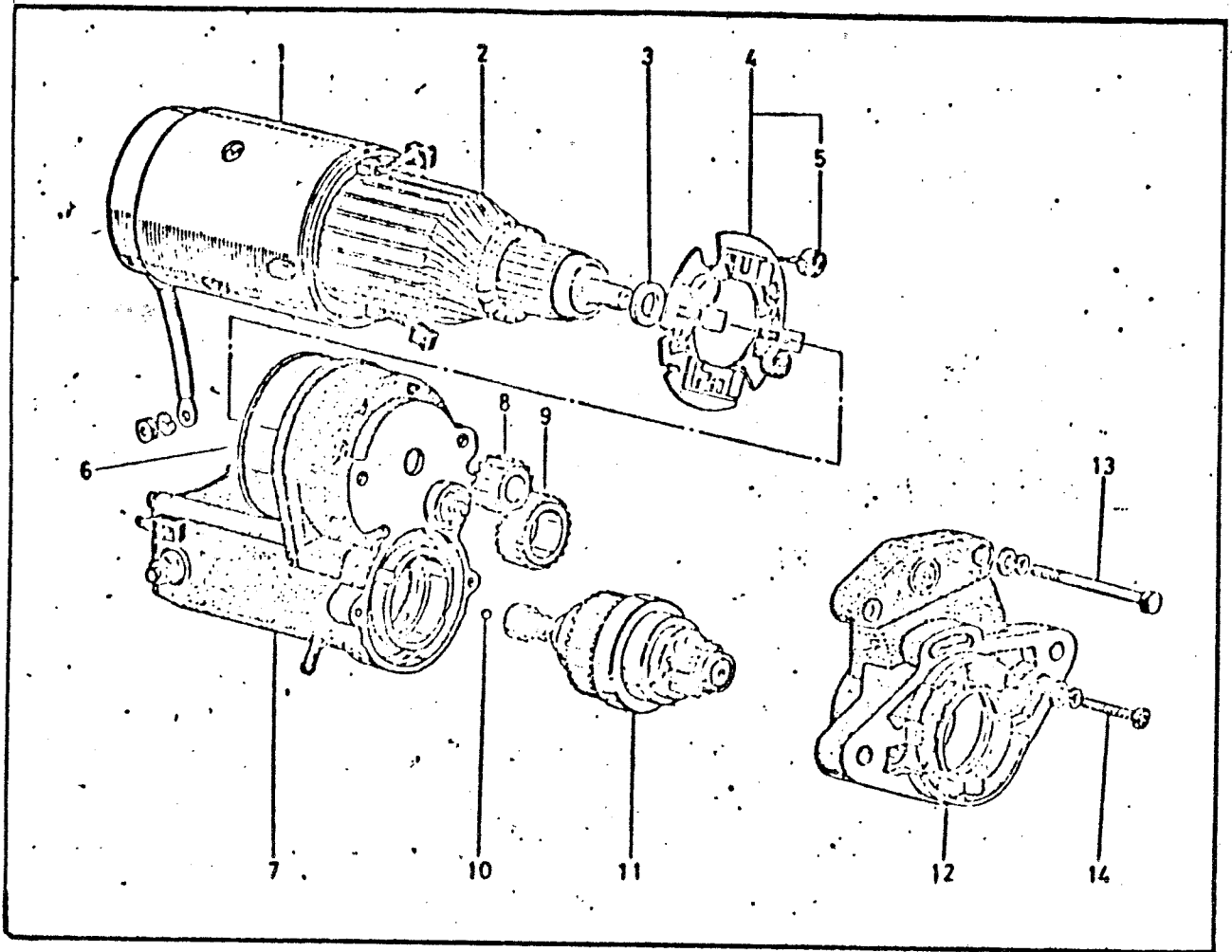

ITEM	PART NO.	DESCRIPTION	UNIT
1	N/A	Yoke	1
2	N/A	Armature	1
3	N/A	Gasket	1
4	N/A	Holder, Brush	1
5	N/A	Spring, Brush	4
6	N/A	Gasket, Brush	1
7	N/A	Switch, Magnet	1
8	N/A	Gear 1	1
9	N/A	Gear 2	1
10	N/A	Ball	1
11	N/A	Clutch	1
12	N/A	Frame, Drive End	1
13	N/A	Bolt, Through	2
14	N/A	Screw	2
299574		Assembly, Starter - Items 1 through 14 (see Flywheel Group also)	1

OIL FILTER GROUP

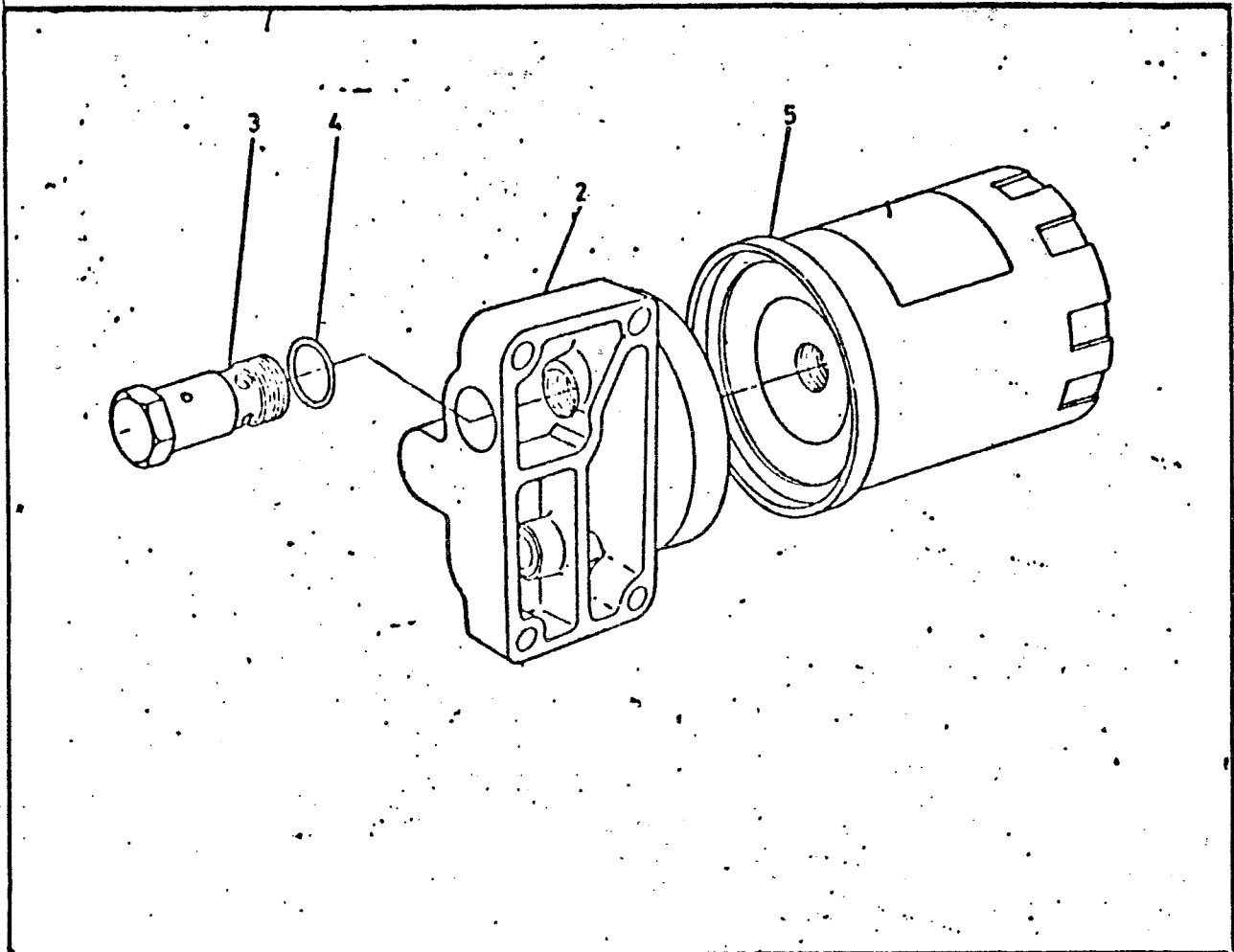

<u>ITEM</u>	<u>PART NO.</u>	<u>DESCRIPTION</u>	<u>UNIT</u>
1 . . .	298860 . . .	Assembly, Cover	1
2 . . .	N/A . . .	Cover	1
3 . . .	N/A . . .	Assembly, Valve, Felief	1
4 . . .	N/A . . .	O Ring	1
5 . . .	299584 . . .	Cartridge, Filter	1

WATER PUMP GROUP

Serial No. Prior to 315023

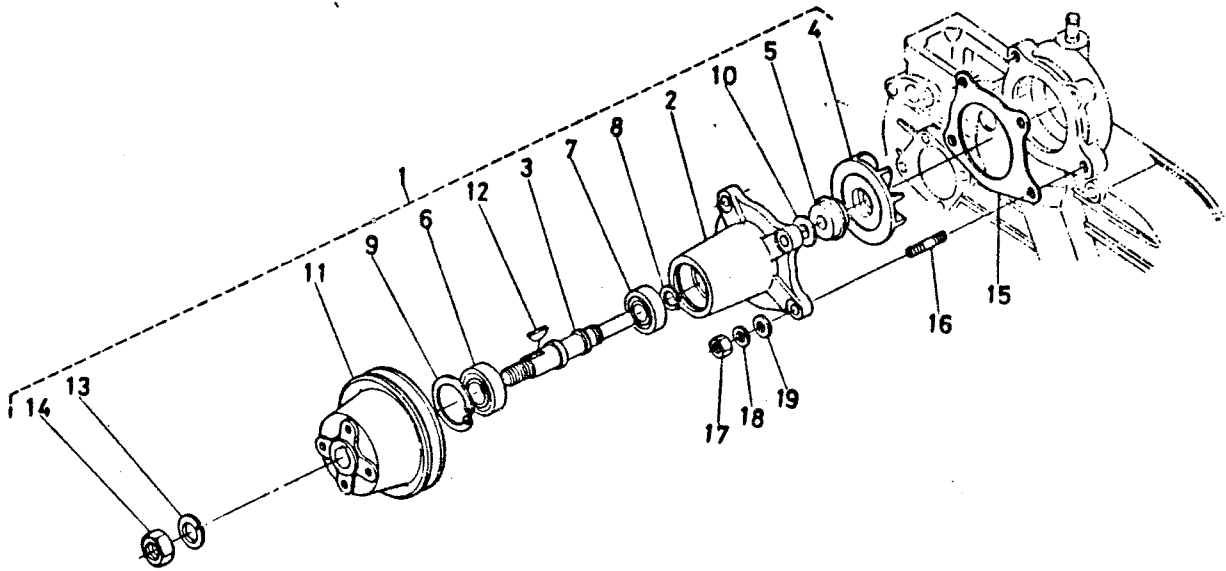

medalist
Universal Motors

FROM SERIAL NO. 230101 TO 230125
315000

ITEM	PART NO.	DESCRIPTION	UNIT
1	298845	Water Pump Assembly	1
2	N/A	Body, Water Pump	1
3	N/A	Shaft, Water Pump	1
4	N/A	Impeller, Water Pump	1
5	N/A	Set Seal	1
6	N/A	Bearing, Ball	1
7	N/A	Bearing, Ball	1
8	N/A	Cir-Clip, External	1
9	N/A	Cir-Clip, Internal	1
10	N/A	Slinger	1
11	N/A	Pulley	1
12	N/A	Key, Woodruff	1
13	N/A	Washer, Spring	1
14	N/A	Nut	1
15	298846	Gasket, Water Pump	1
16	N/A	Stud	4
17	N/A	Nut	4
18	N/A	Washer, Spring	4
19	N/A	Washer, Plain	4
20			
21			
22			
23			
24			

FRESH WATER PUMP GROUP FROM SERIAL NO. 315023 TO

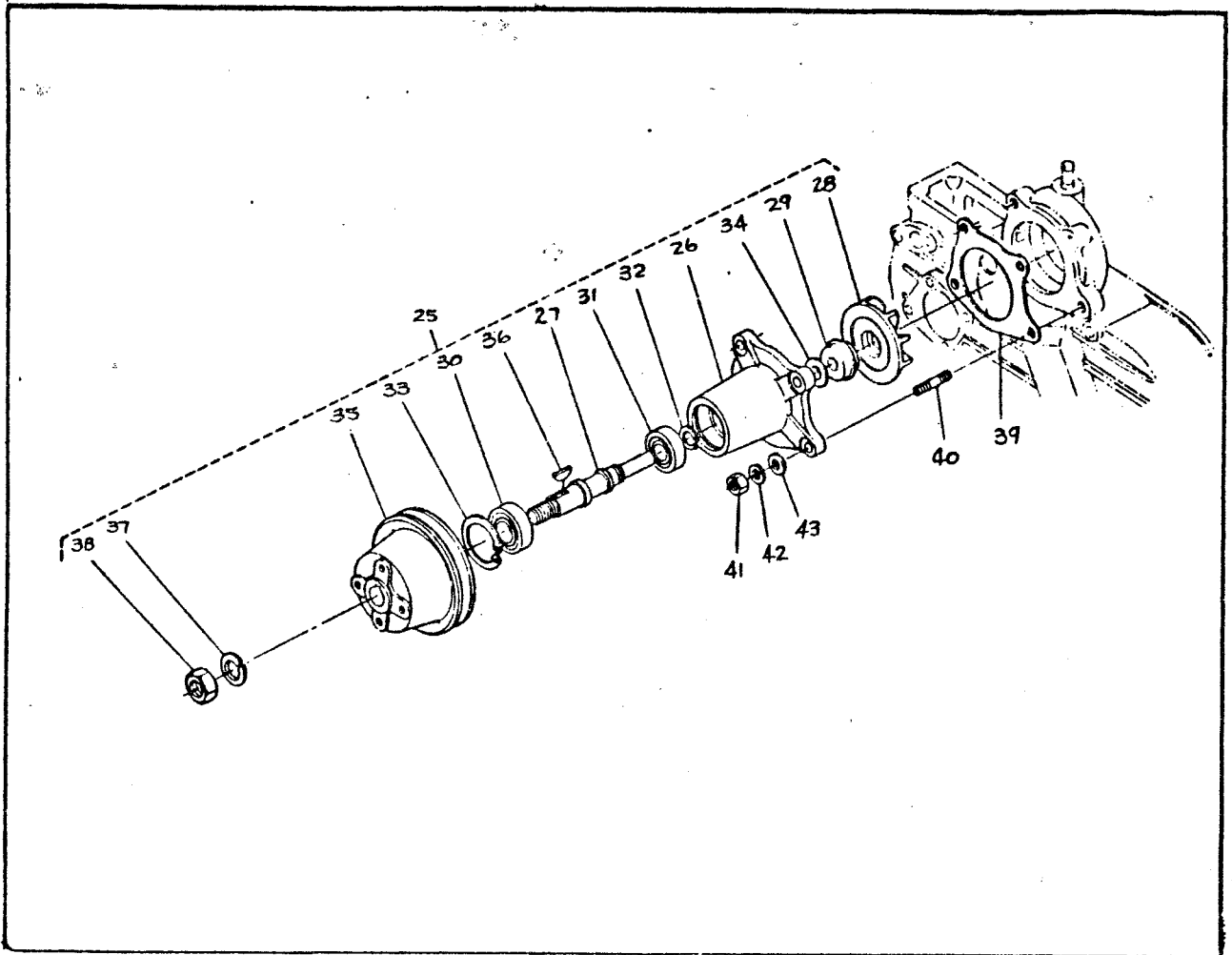

ITEM	PART NO.	DESCRIPTION	UNIT
25	298845	Assembly, Water Pump	1
26	N/A	Body, Water Pump	1
27	N/A	Shaft, Water Pump	1
28	N/A	Impeller, Water Pump	1
29	N/A	Set, Seal	1
30	N/A	Bearing, Ball	1
31	N/A	Bearing, Ball	1
32	N/A	Cir-Clip, External	1
33	N/A	Cir-Clip, External	1
34	N/A	Slinger	1
35	N/A	Pulley	1
36	N/A	Key, Woodruff	1
37	N/A	Washer, Spring	1
38	N/A	Nut	1
39	298846	Gasket, Water Pump	1
40	N/A	Bolt	4
41	N/A	Nut	4
42	N/A	Washer, Spring	4
43	N/A	Washer, Plain	4

FUEL FILTER GROUP

Serial No. Prior to 315023

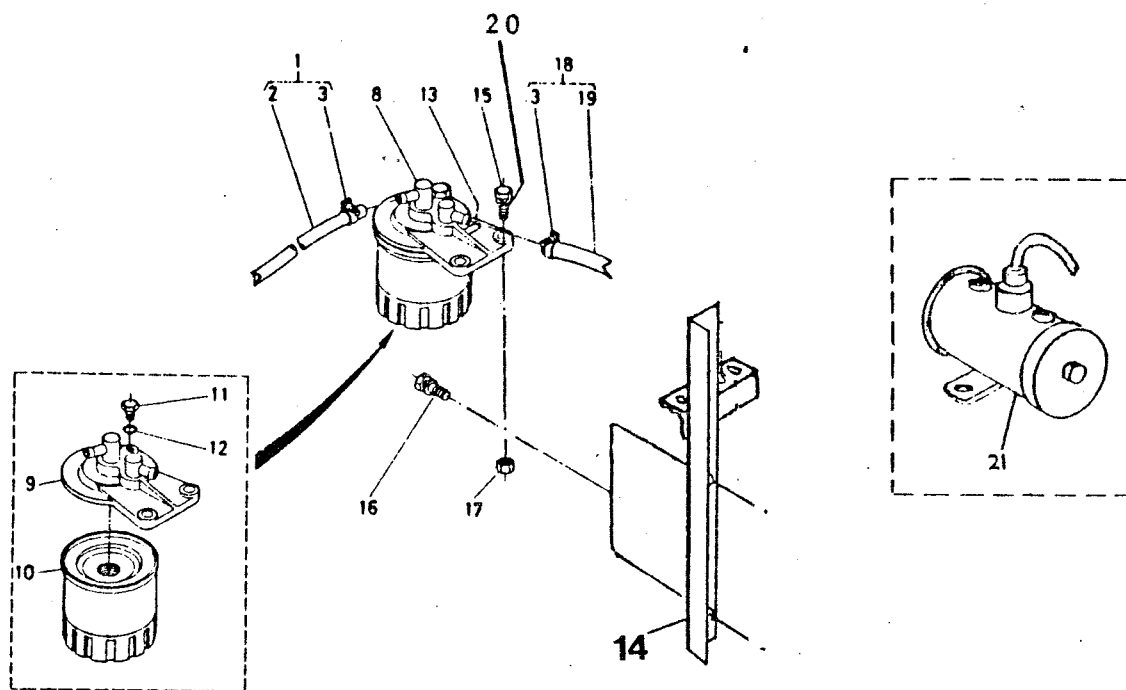

FROM SERIAL NO. 230101 TO 230125
315000 TO 315022

ITEM	PART NO.	DESCRIPTION	UNIT
1	N/A	Fuel Pipe Assembly	1
2	N/A	Pipe, Fuel	1
3	298605-A	Clip, Pipe	2
4	N/A	Gasket	2
5	N/A	Joint, Fuel Pipe	1
6	N/A	Pipe, Fuel	1
7	N/A	Clip, Pipe	2
8	298853	Fuel Filter Assembly	1
9	N/A	Cover, Filter	1
10	298854	Element, Filter	1
11	N/A	Plug, Filter Breather	1
12	N/A	O Ring	1
13	N/A	Mark, Form	1
14	299262	Bracket, Filter	1
15	231059	Bolt	2
16	298973	Bolt	2
17	230142	Nut	2
18	N/A	Fuel Pipe Assembly	1
19	299282	Pipe, Fuel Filter to Engine	1
20	298461	Lockwasher	1
21	297849-A	Electric Fuel Pump	1
22			
23			
24			

FUEL FILTER GROUP

FROM SERIAL NO. 315023 TO

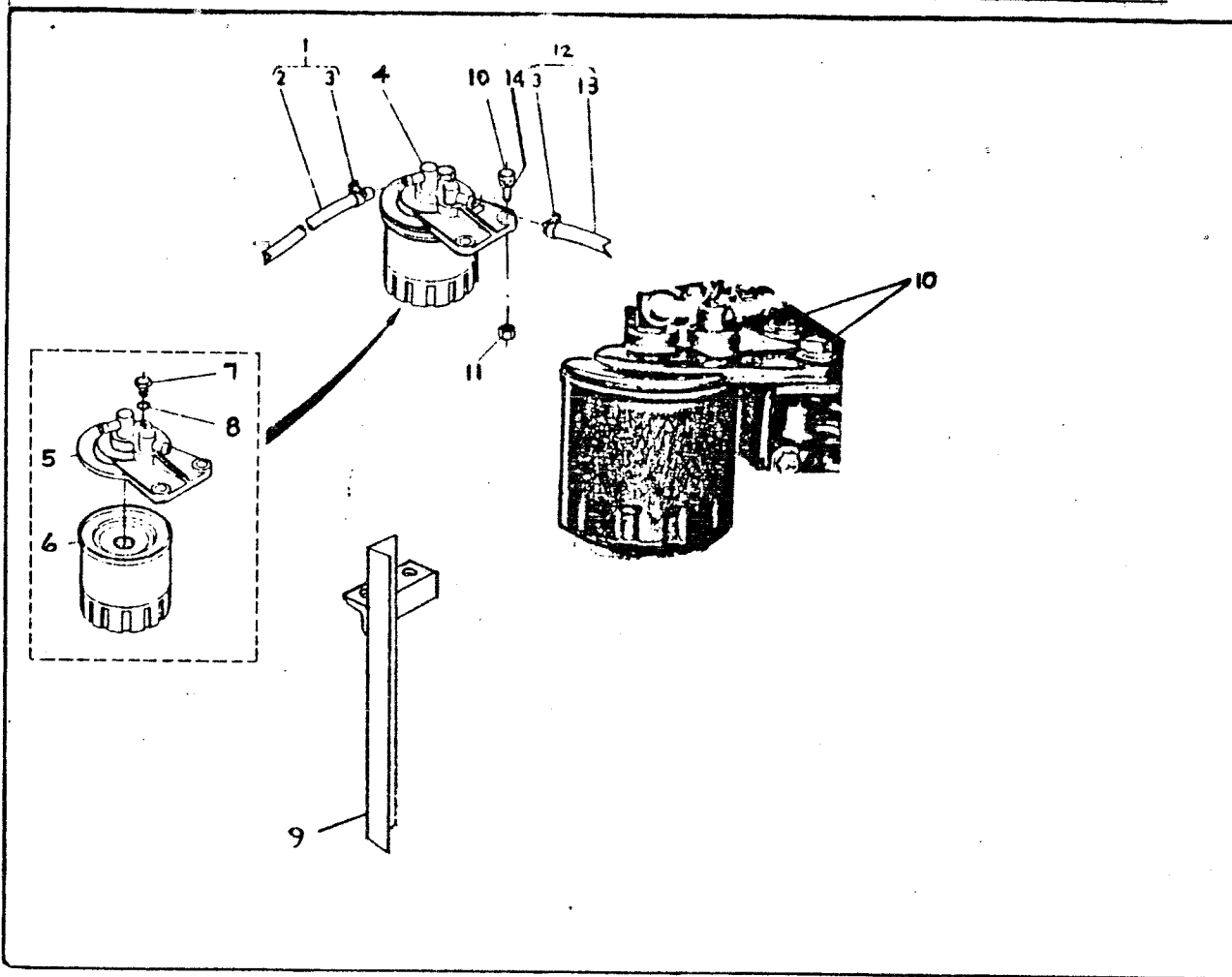

ITEM	PART NO.	DESCRIPTION	UNIT
1 . . .	N/A	Fuel Supply Hose Assembly	1
2 . . .	N/A	Hose, Fuel	1
3 . . .	298605	Clamp, Hose	2
4 . . .	298853	Fuel Filter Assembly	1
5 . . .	N/A	Cover, Filter	1
6 . . .	298854	Element, Fuel Filter	1
7 . . .	N/A	Plug, Filter Breather	1
8 . . .	N/A	O Ring	1
9 . . .	299262	Bracket	1
10 . . .	231059	Bolt	2
11 . . .	230142	Nut	2
12 . . .	N/A	Fuel Hose Assembly	1
13 . . .	299282	Hose, Filter To Injector	1
14 . . .	298567	Lock Washer	2

AIR CLEANER GROUP

Serial No. Prior to 315023

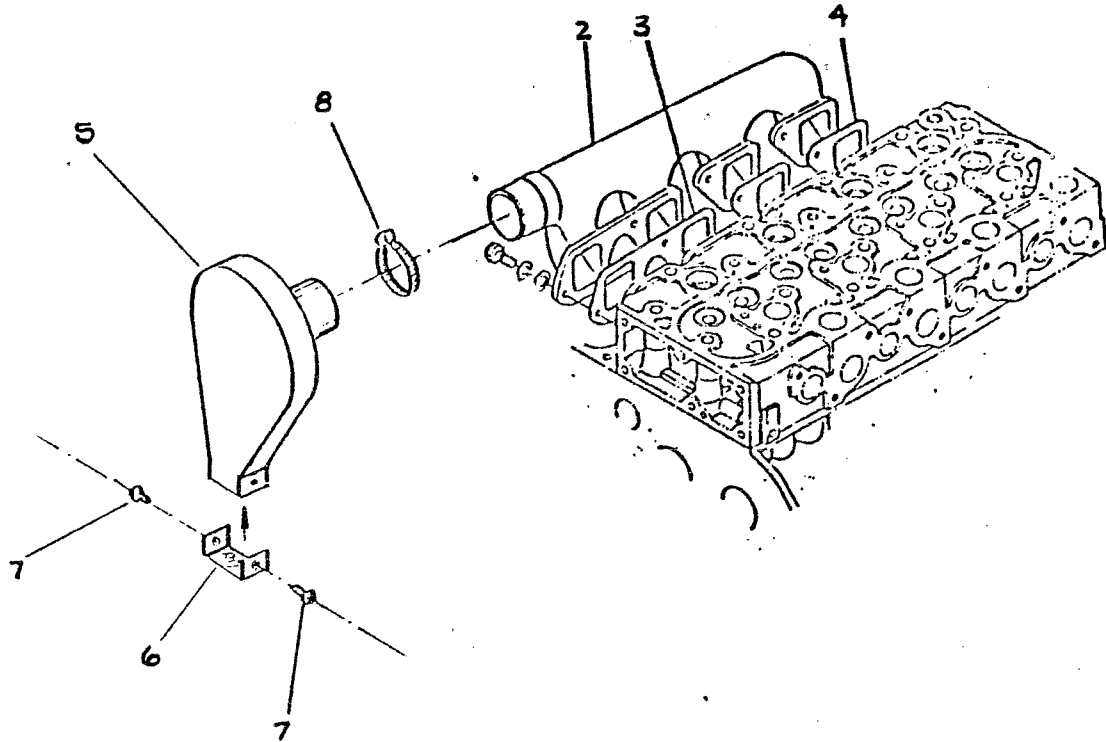

FROM SERIAL NO. 230101 TO 230125
315000 315022

ITEM	PART NO.	DESCRIPTION	UNIT
1	N/A	Air Cleaner Assembly	1
2	299563	Manifold, Inlet	1
3	298705	Gasket	1
4	298865	Gasket, Intake Manifold	2
5	298548-C	Air Silencer	1
6	298563	Screen, Air Silencer	1
7	239158	Pop Rivet	2
8	298604	Clamp, Adjustable	1
9			
10			
11			
12			
13			
14			
15			
16			
17			
18			
19			
20			
21			
22			
23			
24			

AIR CLEANER GROUP

FROM SERIAL NO. 315023 TO

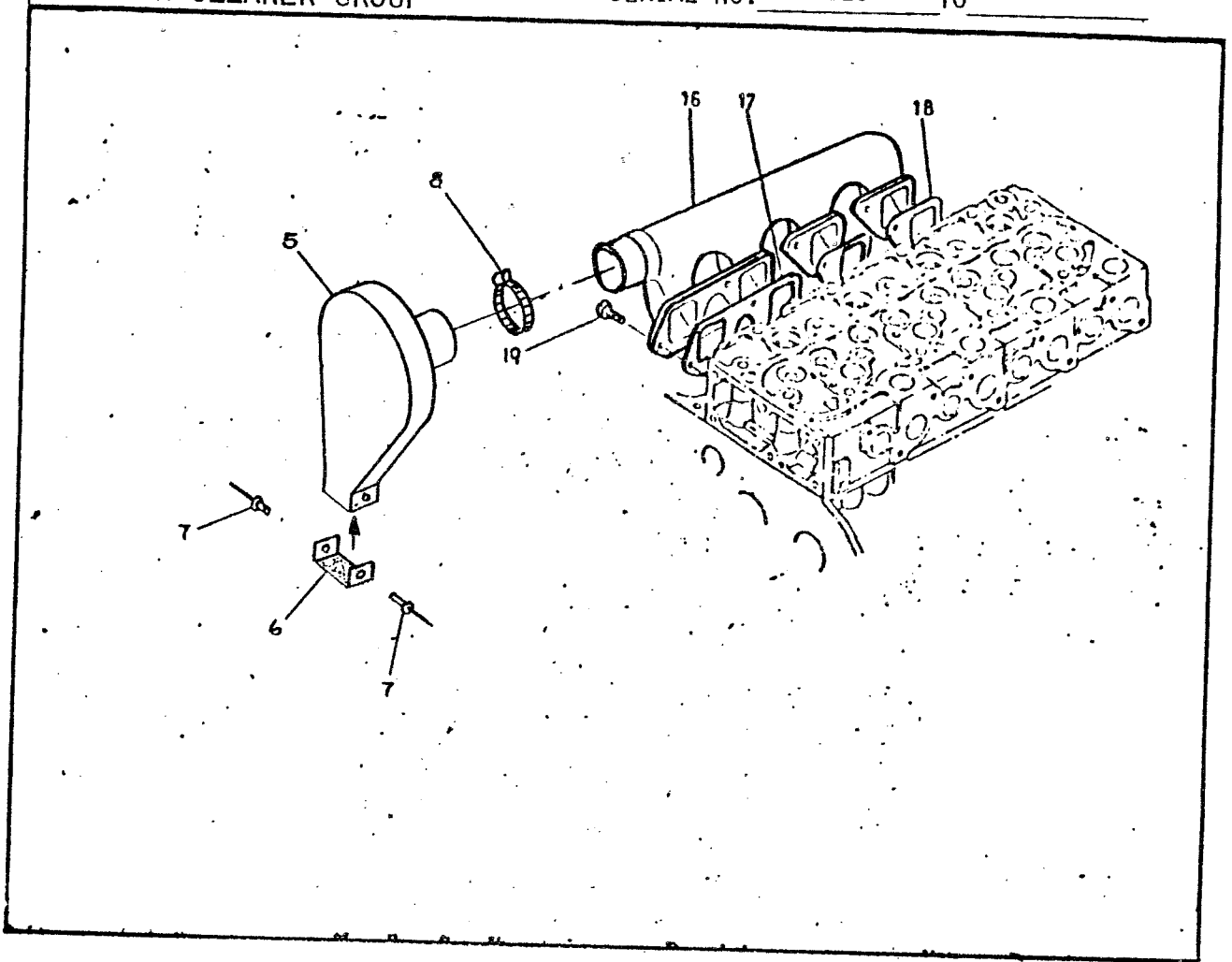

<u>ITEM</u>	<u>PART NO.</u>	<u>DESCRIPTION</u>	<u>UNIT</u>
1 . . .		Assembly, Air Cleaner	1
2 . . .			
3 . . .			
4 . . .			
5 . . .	298548	Air Silencer	1
6 . . .	298563	Screen, Air Silencer	1
7 . . .	239158	Pop Rivet	2
8 . . .	298604	Clamp, Adjustable	1
9 . . .			
10 . . .			
11 . . .			
12 . . .			
13 . . .			
14 . . .			
15 . . .			
16 . . .	299563	Manifold, Inlet	1
17 . . .	298705	Gasket	1
18 . . .	298865	Gasket, Intake Manifold	2
19 . . .	N/A	Bolt.	7

ENGINE MOUNT GROUP

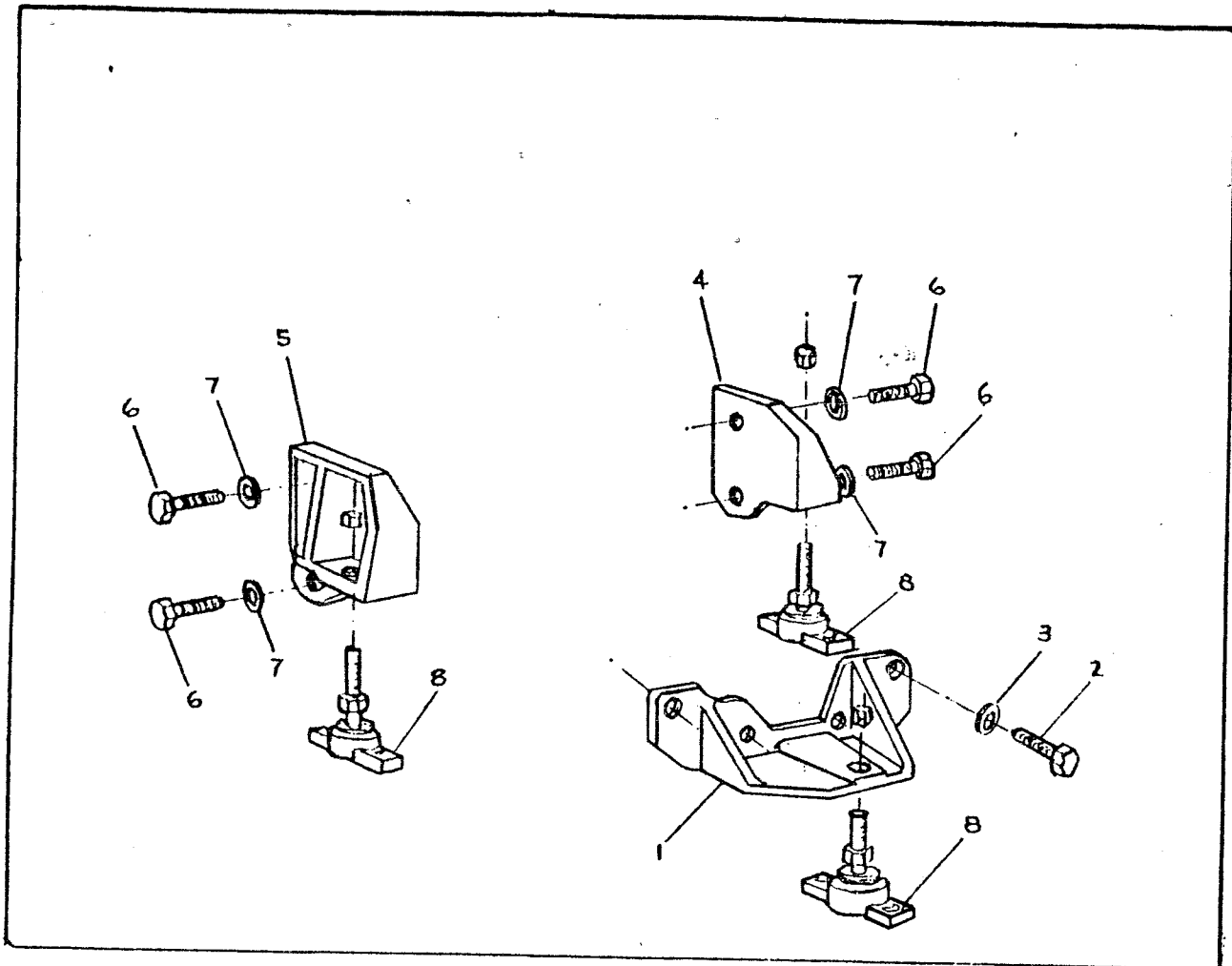

<u>ITEM</u>	<u>PART NO.</u>	<u>DESCRIPTION</u>	<u>UNIT</u>
1 . . .	298515 . . .	Mounting Bracket - Front	1
2 . . .	298506 . . .	Hex Hd Cap Screw(10MM x 30MM Lg)	4
3 . . .	298463 . . .	Lock Washer-Split (10MM Screw)	4
4 . . .	298517 . . .	Mounting Bracket - Rear L.H.	1
5 . . .	298519 . . .	Mounting Bracket - Rear R.H.	1
6 . . .	298464 . . .	Hex Hd. Cap Screw (14MM x 35MM Lg)	4
7 . . .	298465 . . .	Lock Washer - Split (14MM Screw)	4
8 . . .	298232 . . .	Flexible Mount	3

When using the four point mount option mounting bracket (Item 1) must be part no. 299706 and one extra 298232 mount is required.

TRANSMISSION GROUP

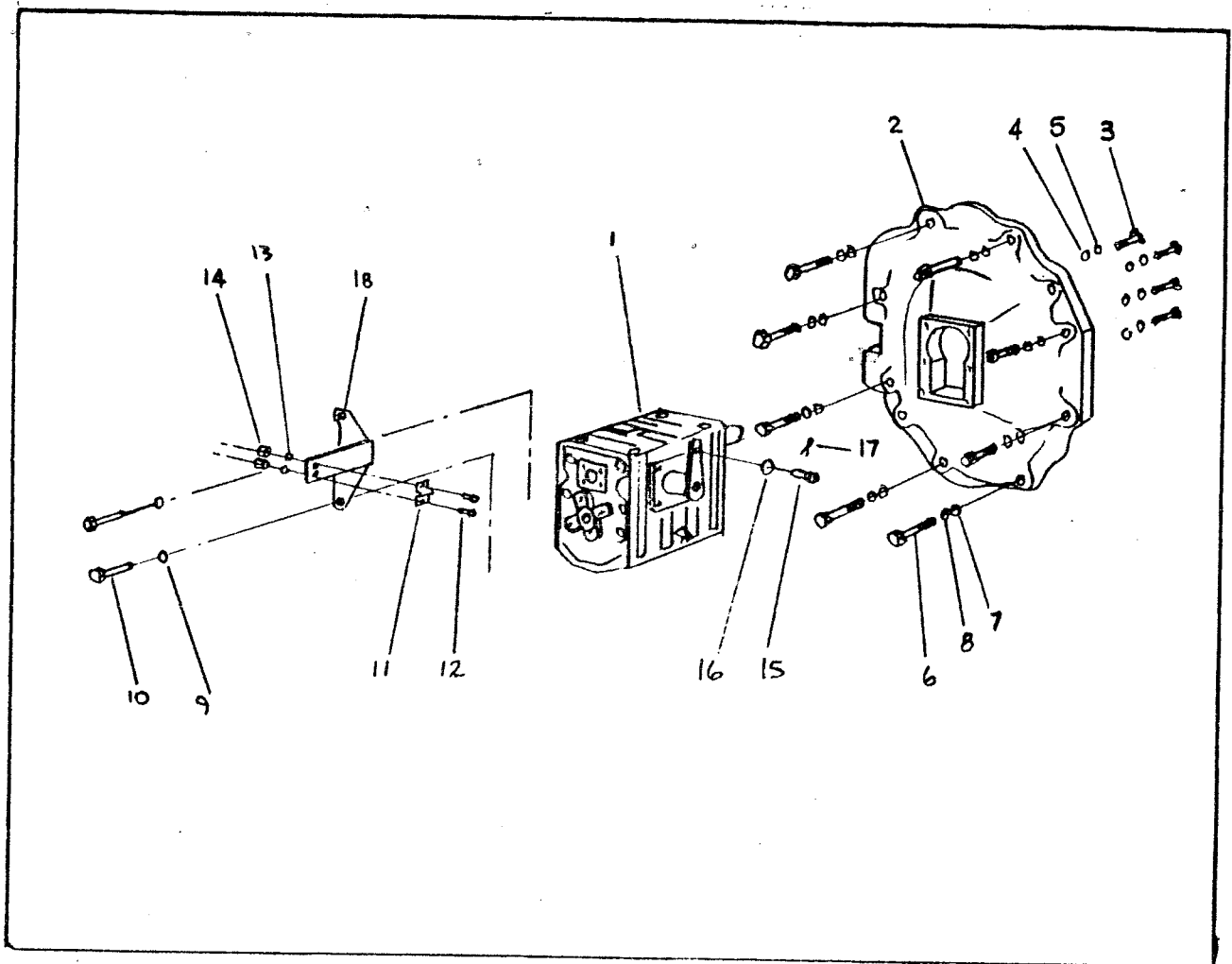

ITEM	PART NO.	DESCRIPTION	UNIT
1 . . .	298453 . . .	Reverse Gear Box, Complete.	1
2 . . .	298523 . . .	Bell Housing, Reverse Gear	1
3 . . .	298468 . . .	Hex Hd Cap Scr(8MM x 1.25P x 25MM Lg) . . .	6
4 . . .	231875 . . .	Flat Washer, SAE 5/16	6
5 . . .	298461 . . .	Washer, Lock (8MM Screw)	6
6 . . .	298616 . . .	Hex Hd Cap Scr(10MM x 50MM Lg).	6
7 . . .	298456 . . .	Flat Washer (.413 I.D.)	6
8 . . .	298463 . . .	Lock Washer, Split (10MM Screw)	6
9 . . .	298461 . . .	Lock Washer, Split (8MM Screw)	2
10 . . .	298895 . . .	Hex Hd Cap Scr(8MM x 1.25P x 16MM Lg) . . .	2
11 . . .	298897 . . .	Clamp, Shift Cable to Shift Control Bracket	1
12 . . .	231224 . . .	Round Hd Mach Scr(#10-32 x 1/2 Lg)	2
13 . . .	231890 . . .	Lock Washer, Split (#10 Screw)	2
14 . . .	230138 . . .	Hex Nut (#10-32).	2
15 . . .	299690 . . .	Pivot, Shift Cable to Reverse Gear Lever.	1
16 . . .	231874 . . .	Flat Washer SAE 1/4"	1
17 . . .	230281 . . .	Cotter Pin 3/32 x 1/2"	1
18 . . .	298896 . . .	Bracket, Shift Control Mt'g Cable	1

THROTTLE LINKAGE CONTROL GROUP

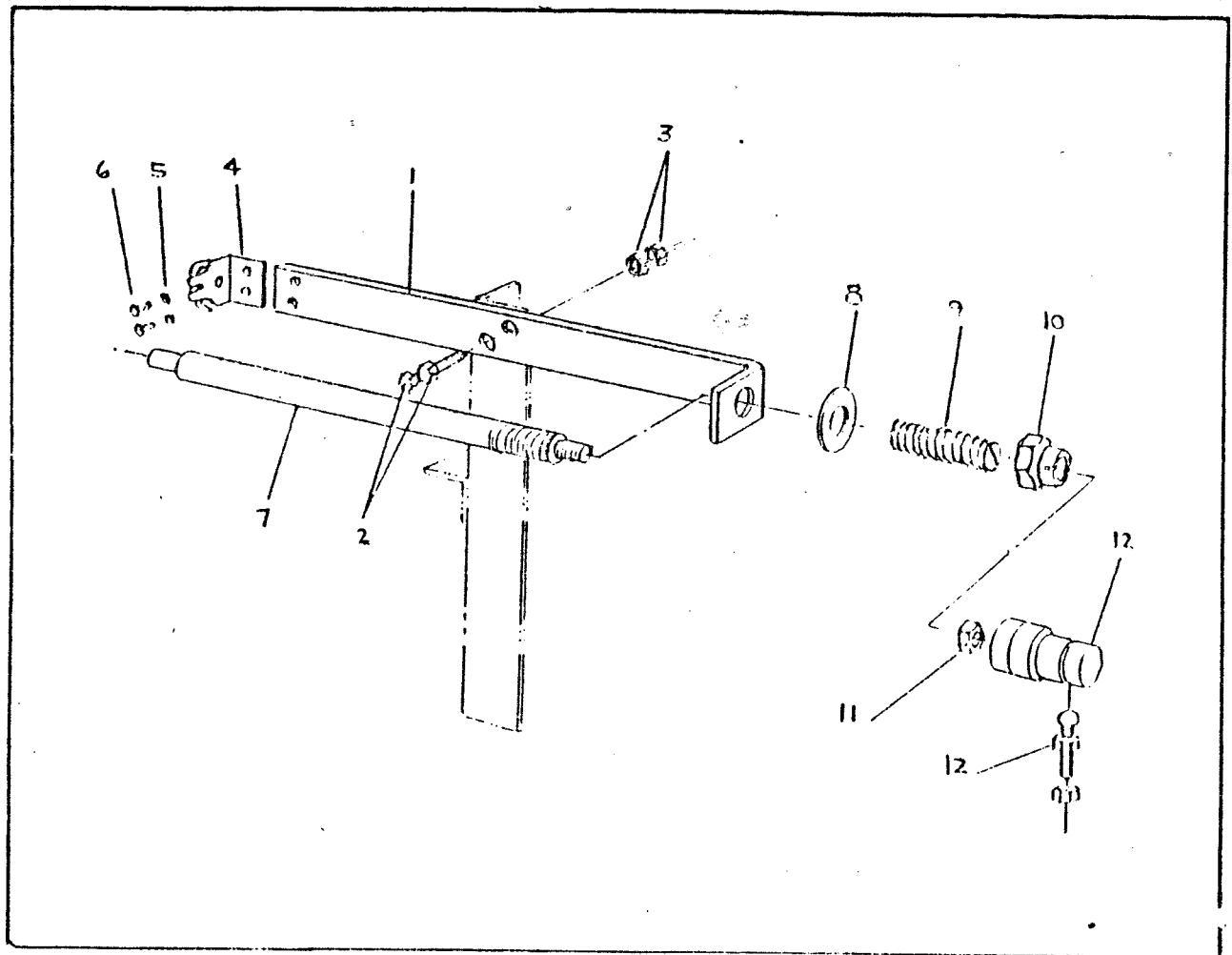

<u>ITEM</u>	<u>PART NO.</u>	<u>DESCRIPTION</u>	<u>UNIT</u>
1 . . .	298637 . . .	Bracket-Throttle Cable Mtg.	1
2 . . .	231035 . . .	Hex Hd Cap Screw(1/4-20 x 3/4" Lg)	2
3 . . .	230257 . . .	Lock Nut-Flexlock (1/4-20)	2
4 . . .	298630 . . .	Cable Hook Clip	1
5 . . .	231890 . . .	Lock Washer, Split (#10)	2
6 . . .	231224 . . .	Rd Hd Machine Screw(#10-32 x 1/2" Lg)	2
7 . . .	298638 . . .	Stud-Throttle Control Linkage	1
8 . . .	231875 . . .	Flat Washer SAE 5/16	1
9 . . .	298886 . . .	Spring, Throttle Stop	1
10 . . .	298610 . . .	Lock Nut, Flexlock (5/16 x 24)	1
11 . . .	230138 . . .	Hex, Nut (#10-32)	1
12 . . .	298629 . . .	Ball Joint, Throttle Linkage	1

ALTERNATOR GROUP

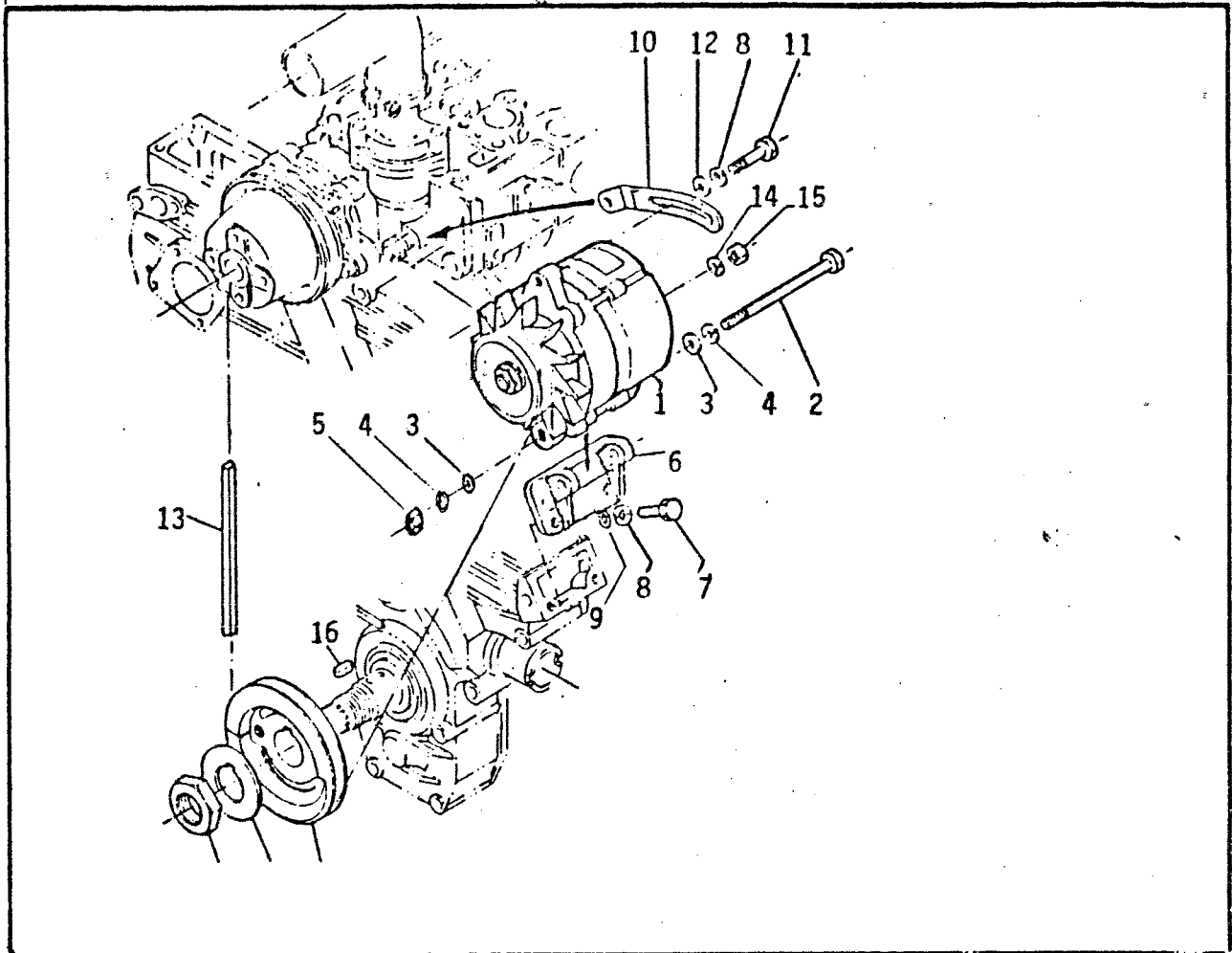

<u>ITEM</u>	<u>PART NO.</u>	<u>DESCRIPTION</u>	<u>UNIT</u>
1 . . .	298972 . . .	55 AMP Alternator & Tach A.C. Tap Kit . . .	1
2 . . .	231093 . . .	Hex Hd Cap Screw(3/8-16 x 3-3/4 Lg) . . .	1
3 . . .	231876 . . .	Washer, SAE 3/8"	2
4 . . .	285305 . . .	Washer, Split Lock 3/8"	1
5 . . .	230144 . . .	Hex Nut, 3/8-16	1
6 . . .	298521 . . .	Alternator Mounting Bracket	1
7 . . .	298468 . . .	Hex Hd Cap Screw(8MM x 1.25 x 25MM) . . .	2
8 . . .	298461 . . .	Washer Lock (8MM Screw)	3
9 . . .	231875 . . .	Washer, Flat SAE 5/16	2
10 . . .	298471 . . .	Alternator Adjusting Arm	1
11 . . .	231057 . . .	Hex Hd Cap Screw(5/16-18 x 3/4" Lg) . . .	1
12 . . .	231856 . . .	Washer, Flat Plain 5/16"	1
13 . . .	299007 . . .	"V" Belt	1
14 . . .		(Supplied with Washer, Spring Alternator)	1
15 . . .		Nut	1
16 . . .	N/A . . .	Key, Feather	1
17 . . .	N/A . . .	Pulley	1
18 . . .	298837 . . .	Washer, Crankshaft	1
19 . . .	298836 . . .	Nut, Crankshaft	1

COOLING SYSTEM GROUP

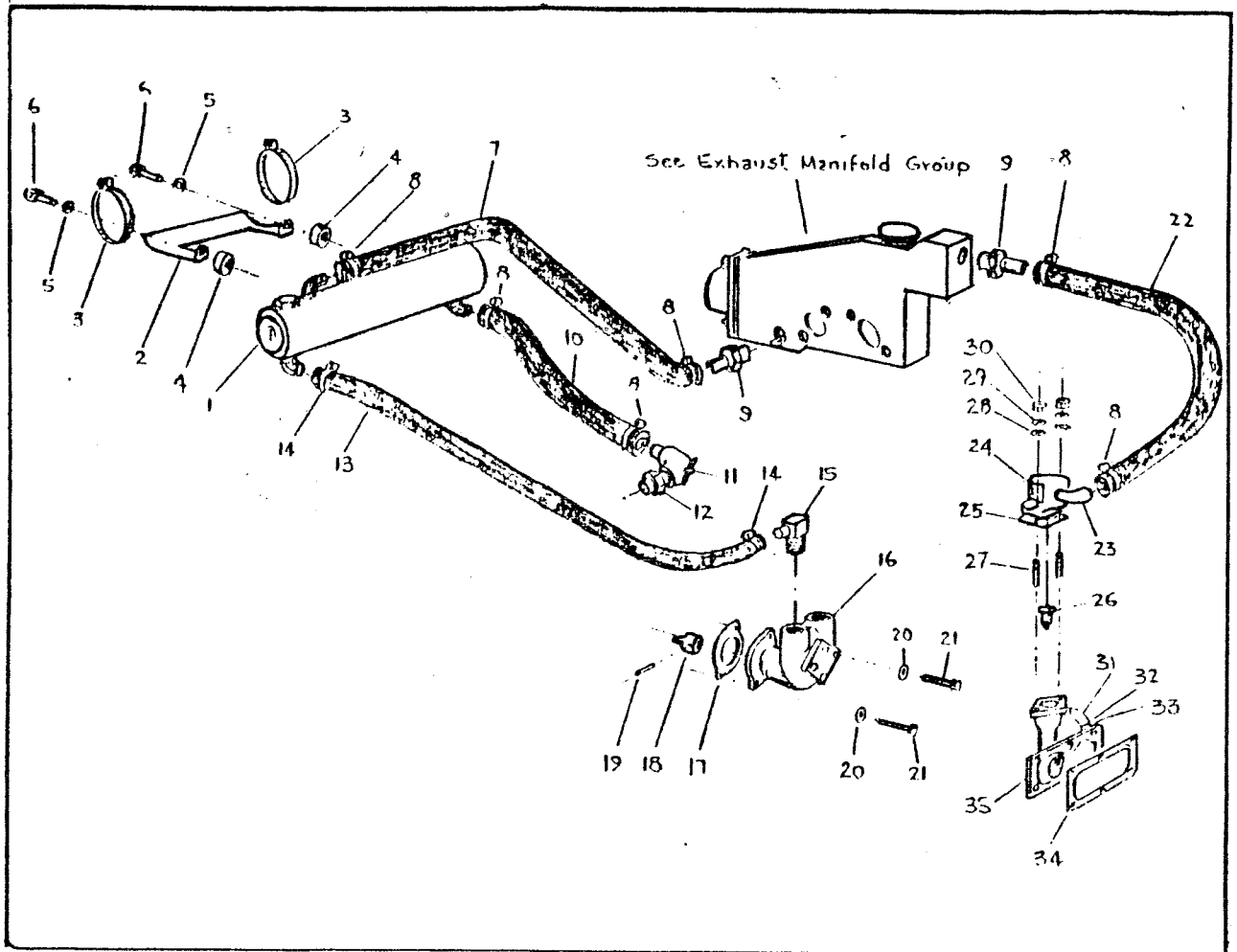

ITEM	PART NO.	DESCRIPTION	UNIT
1	299049	Heat Exchanger	1
2	298632	Support Bracket	1
3	294386	Clamp, Heat Exchanger	2
4	298634	Spacer	2
5	298463	Washer, Lock Split (10MM Screw)	2
6	298617	Hex Hd Cap Screw(10MM x 1.25P x 55MM)	2
7	299079	Wire Flex Hose 7/8 ID x 10-3/4 Lg.	1
8	298648	Hose Clamp For 7/8 Hose	6
9	286075	Hose Connector - 3/4 MPT to 7/8 ID Hose	2
10	299080	Hose 7/8 ID x 22" Lg.	1
11	239138	Drain Cock 1/8"	1
12	298641	Hose and Drain Adapter	1
13	299081	Hose 1/2 I.D. x 28" Lg.	1
14	374747	Hose Clamp	2
15	241019	Hose Fitting 90° x 3/8	1
16	298890	Raw Water Pump	1
17	261044	Gasket, Raw Water Pump Mtg.	1
18	298478	Coupling, Water Pump	1
19	230371	Roll Pin, 3/16 x 7/8 Lg.	1
20	285305	Washer, Lock Split 3/8	2
21	231080	Hex Hd Cap Scr.(3/8-16 x 1" Lg)	2
22	298645	Hose 7/8 I.D. x 5-1/8 Lg.	1
23	298644	Hose Connector	1

COOLING SYSTEM GROUP

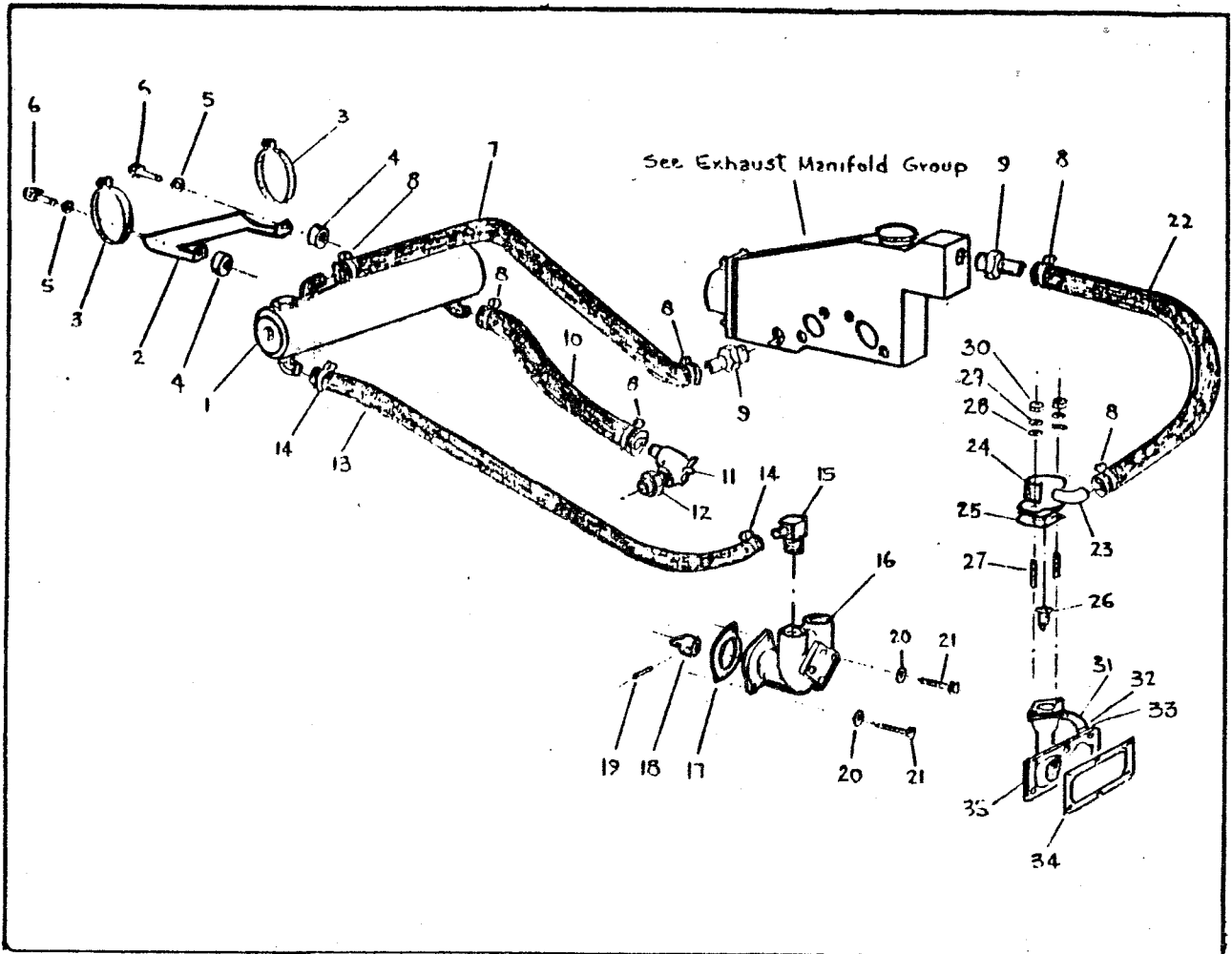

ITEM	PART NO.	DESCRIPTION	UNIT
24	298583	Thermostat Housing	1
25	298843	Gasket, Thermostat Housing	1
26	299798	Thermostat Element	1
27	N/A	Stud	2
28	N/A	Washer, Plain	2
29	N/A	Washer, Lock Split	2
30	N/A	Hex Nut	2
31	298841	Hose, Water Return	1
32	298842	Clamp, Hose	2
33	298840	Pipe, Water Return	1
34	298839	Gasket, Water Flange	1
35	298838	Flange, Water	1
36	299066	Temperature Sender	1

WATER PUMP GROUP

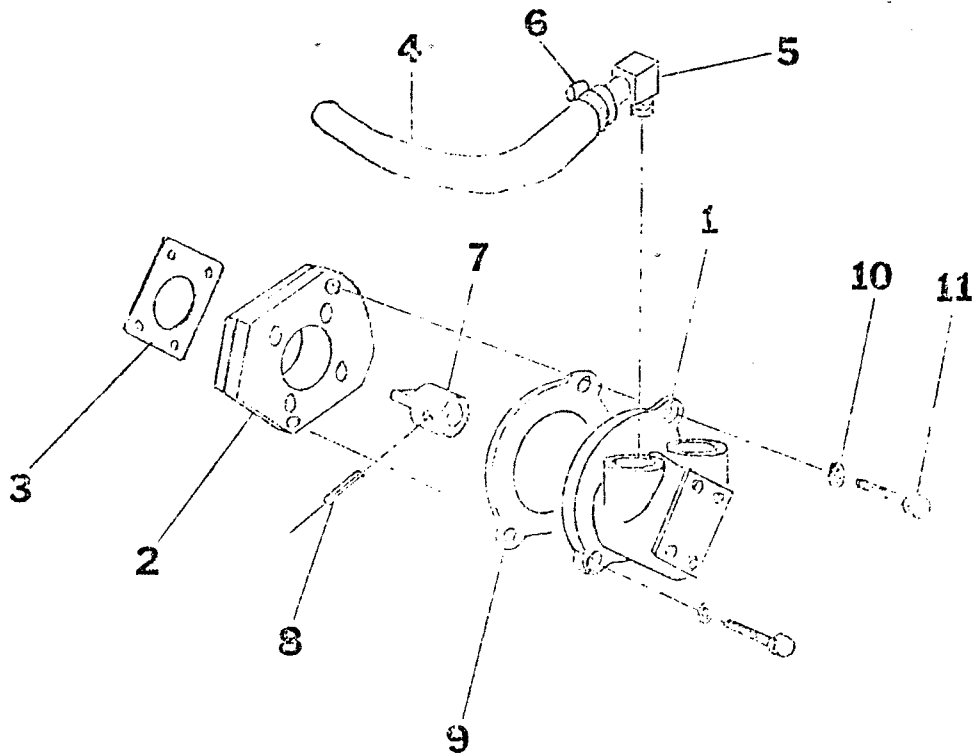

<u>ITEM</u>	<u>PART NO.</u>	<u>DESCRIPTION</u>	<u>UNIT</u>
1 . . .	298890 . . .	Pump Oberdorfer	1
2 . . .	298477 . . .	Adapter Plate	1
3 . . .	298485 . . .	Gasket, Adapter Plate	1
4 . . .	299162 . . .	Hose 1/2" Pump To Engine	1
5 . . .	241019 . . .	Fitting 90° 1/2" Hose	1
6 . . .	374747 . . .	Clamp 1/2" Hose	1
7 . . .	298478 . . .	Coupling Adapter	1
8 . . .	230371 . . .	Roll Pin 3/16 Dia. x 7/8 Lg.	1
9 . . .	261044 . . .	Gasket	1
10 . . .	285305 . . .	Washer	2
11 . . .	231080 . . .	Cap Screw	2
12 . . .	298889 . . .	Cam	1

When replacing pump impeller order "water pump repair kit"
 Part No. 298416-A. Kit consists of: impeller, lip seal,
 gasket and retaining ring.

EXHAUST MANIFOLD GROUP

Serial No. Prior to 315023

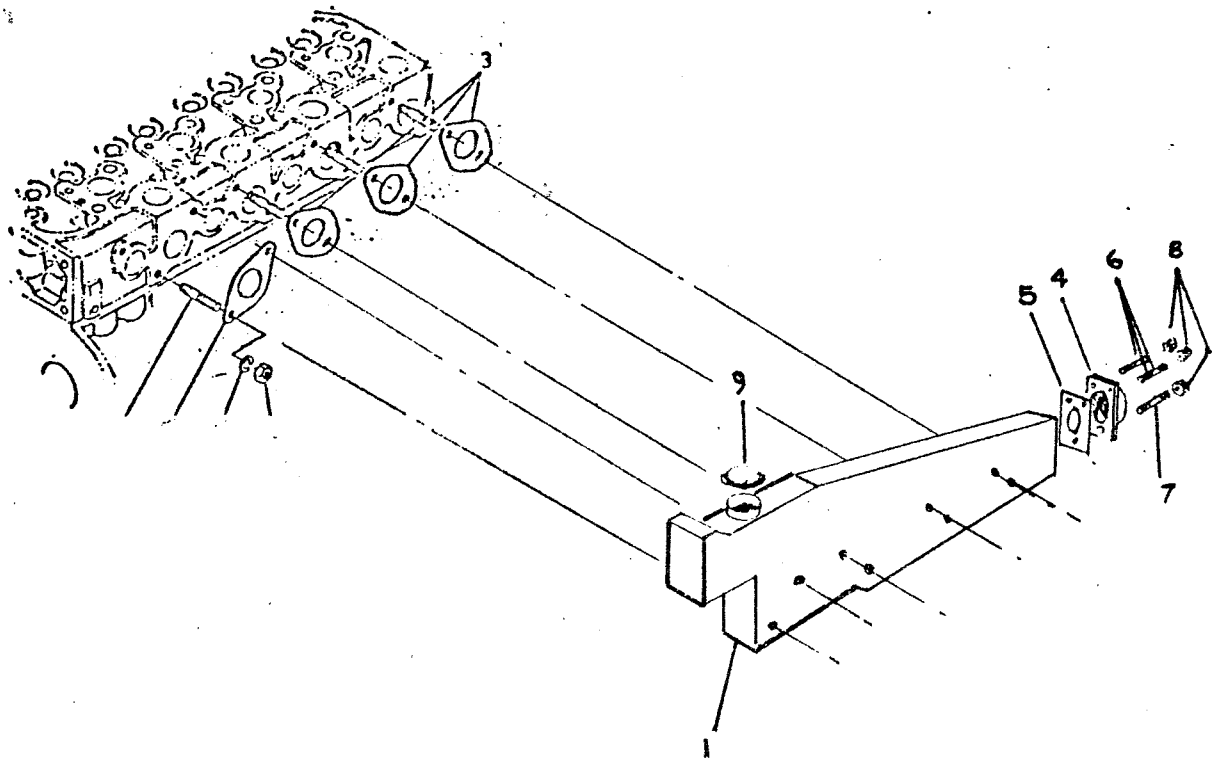

FROM SERIAL NO. 230101 TO 230125
315000 315022

ITEM	PART NO.	DESCRIPTION	UNIT
1	298988	Manifold	1
2	298707	Gasket, Exhaust Manifold	1
3	298708	Gasket, Exhaust Manifold	1
4	298599	Exhaust Flange, Manifold	3
5	298600	Exhaust Flange, Manifold	1
6	298600	Gasket, Exhaust Flange	1
7	276440	Stud, Exhaust Flange Mounting	2
8	298974	Stud, Exhaust Flange Mounting	1
9	230147	Hex Nut, Exhaust Flange Mtg. 3/8-24	3
10	298576	Radiator Cap, Pressurized 7# PSI	1
11	298635	Stud, Exhaust Manifold	8
12	298466	Hex Nut, Exhaust Manifold (8MM x 1.25P)	8
13			
14			
15			
16			
17			
18			
19			
20			
21			
22			
23			
24			

EXHAUST MANIFOLD GROUP FROM SERIAL NO. 315023 TO

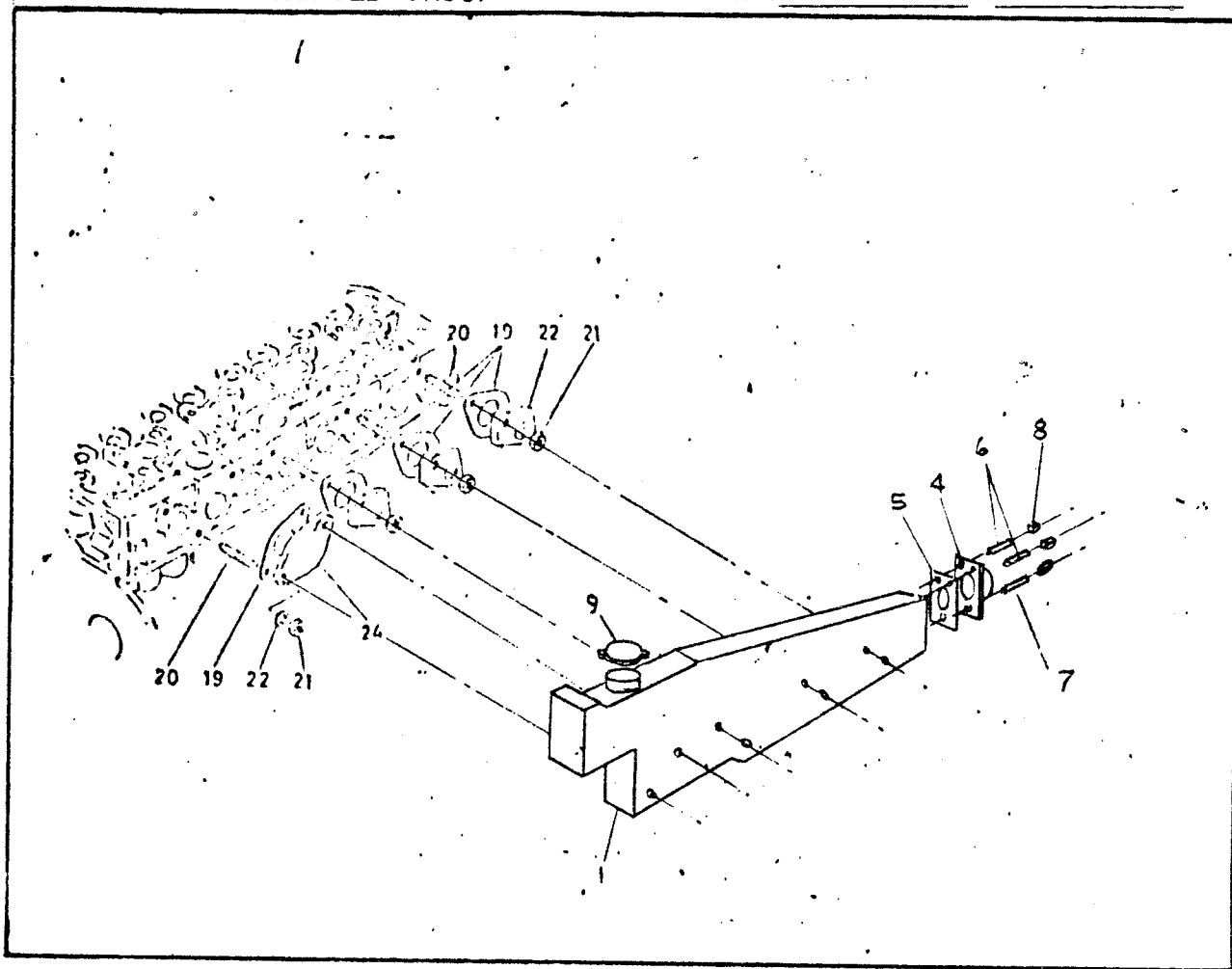

12504 -

ITEM	PART NO.	DESCRIPTION	UNIT
1	298988	Manifold	1
2			
3			
4	298599	Exhaust Flange	1
5	298600	Gasket, Exhaust Flange	1
6	276440	Stud, Exhaust Flange Mounting	2
7	298974	Stud, Exhaust Flange Mounting	1
8	230147	Hex Nut, Exhaust Flange Mounting 3/8-24	3
9	298576	Radiator Cap, Pressurized 7 P.S.I.	1
10	298635	Stud, Exhaust Manifold	8
11	298466	Hex Nut, Exhaust Manifold(8MM x 1.25 P)	8
12			
13			
14			
15			
16			
17			
18			
19	298707	Gasket, Exhaust Manifold	4
20	N/A	Stud	8
21	N/A	Nut	8
22	N/A	Washer, Spring	8
23			
24	N/A	Cover	4

COUPLING GROUP

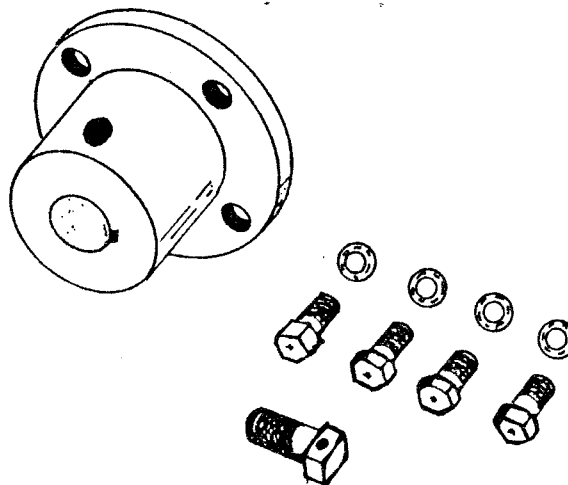

ITEM	PART NO.	DESCRIPTION	UNIT
	299640	Rigid Coupling 3/4"	
	299641	Rigid Coupling 7/8"	
	299642	Rigid Coupling 1"	
	299643	Rigid Coupling 1-1/8"	
	299644	Rigid Coupling 1-1/4"	
	238162	Screw-Sq.Hd. 3/8 - 16 x 1"	2
	239548	Screw-Hex Hed. 3/8 - 24 x 1-1/4"	4
	231910	Washer-Shake Proof	4
	230189	Nut-Jam 3/8-24	4
	298568	Flexible Coupling 3/4" - 1/4" Key	
	298569	Flexible Coupling 7/8" - 1/4" Key	
	298484	Flexible Coupling 1" - 1/4" Key	
	298570	Flexible Coupling 1-1/8" - 1/4" Key	
	299300	Flexible Coupling 1-1/4" - 5/16" Key	

INSTRUMENT PANEL

<u>PART NO.</u>	<u>DESCRIPTION</u>	<u>UNIT</u>
298559	Instrument Panel Complete	Optional
298572	Panel	1
298385	Ammeter	1
299240	Oil Indicator Light	1
298383	Temperature Gauge	1
299190	Ignition Switch	1
299650	Blower Switch	1
299754	Blower Switch Plate	1
299839	Glo Plug Switch	1
299755	Glo Plug Switch Plate	1
299756	Caution Plate	1
299651	Fuse - 10A	1
299066	Temperature Sender - 1/4"	1
298584	Panel Harness	1
298585	10 Ft. Extension Harness	1
298586	Engine Wire Harness	1
OR		
299732	Instrument Panel Complete with 299263 Tachometer and All Other Components Listed Above.	
256738	Gasket Set	Optional
256749	Spare Parts Kit	Optional

Electrical System

ENGINE CONNECTIONS

Universal Diesel

PANEL CONNECTIONS

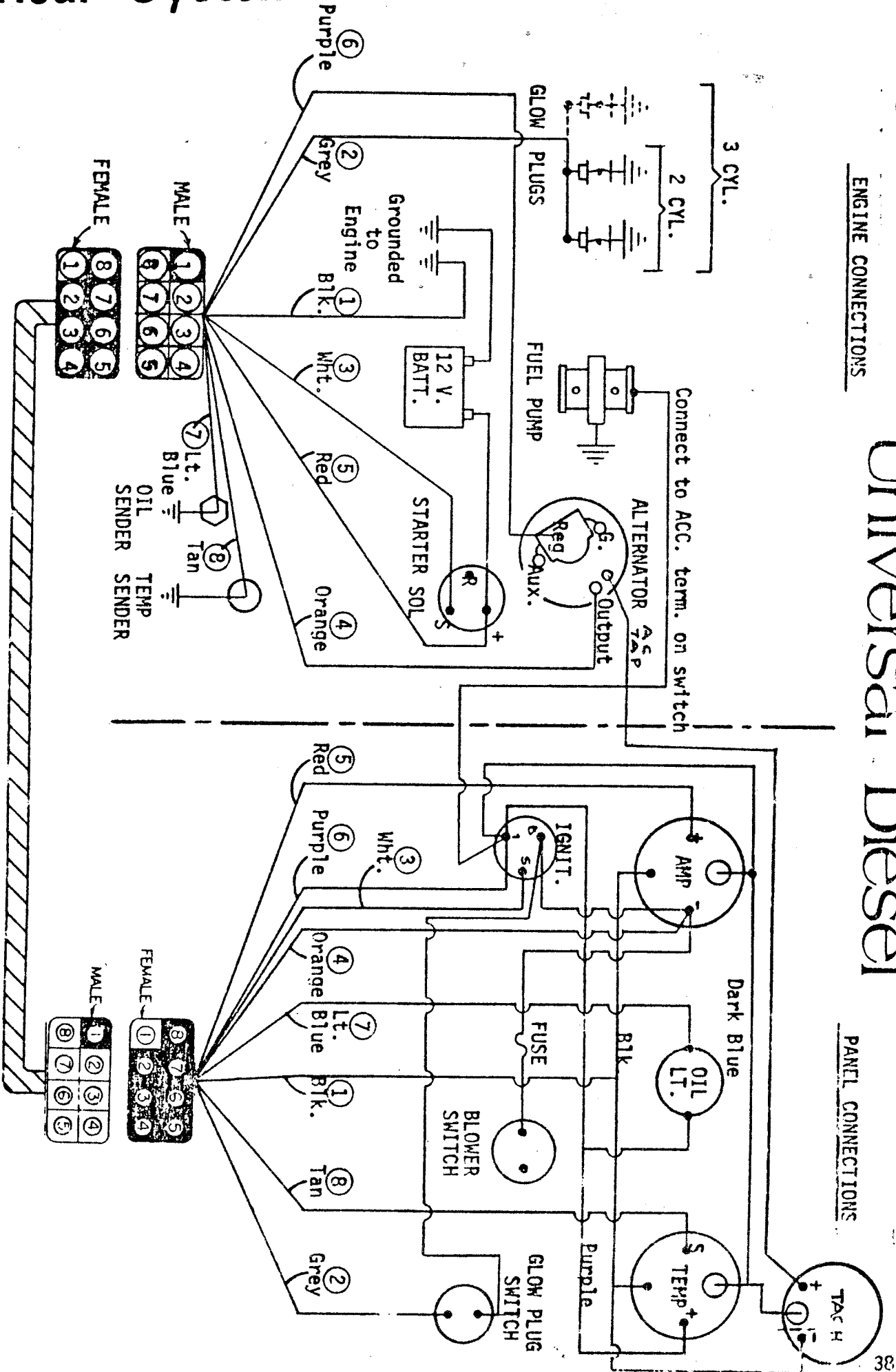

medalist 
Universal Motors

Post Office Box 3008

OSHKOSH, WI 54903 • (414) 231-4100 • CABLE: UNIMOT • TLX 262-717